

Public Document Pack



Date: 8 December 2014
Ask For: James Clapson
Direct Dial: (01843) 577200
Email: james.clapson@thanet.gov.uk

JOINT TRANSPORTATION BOARD

16 DECEMBER 2014

A meeting of the Joint Transportation Board will be held at **7.00 pm on Tuesday, 16 December 2014** in the Council Chamber, Cecil Street, Margate, Kent.

Membership:

Councillor Latchford (Kent County Council - Birchington and Villages) (Chairman); Councillors: Clark (Thanet District Council) (Vice-Chairman), Aldred (Thanet District Council), K Gregory (Thanet District Council), S Hart (Thanet District Council), D Saunders (Thanet District Council), M Saunders (Thanet District Council), Savage (Thanet District Council), J Scobie (Thanet District Council), M Elenor (Kent County Council - Margate & Cliftonville), J Elenor (Kent County Council - Margate West), Heale (Kent County Council - Ramsgate), W Scobie (Kent County Council - Margate and Cliftonville Electoral Division), Shonk (Kent County Council - Ramsgate), Terry (Kent County Council - Broadstairs and Sir Moses Montefiore), Wiltshire (Kent County Council - Broadstairs and Sir Moses Montefiore Electoral Division) and Hovenden (Thanet Area Local Councils' Committee)

A G E N D A

Item No

1. **APOLOGIES FOR ABSENCE**
2. **DECLARATIONS OF INTEREST**
3. **MINUTES OF PREVIOUS MEETING** (Pages 1 - 4)
To approve the Minutes of the Joint Transportation Board meeting held on 18 September 2014, copy attached.
4. **RELOCATION OF MARGATE MARKET** (Pages 5 - 10)
5. **THANET PARKWAY RAILWAY STATION** (Pages 11 - 24)
6. **MINSTER SECTION 106 IMPROVEMENTS** (Pages 25 - 30)
7. **HIGHWAY WORKS PROGRAMME 2014/15** (Pages 31 - 44)
8. **LOCAL WINTER SERVICE PLAN** (Pages 45 - 46)
9. **TRAFFIC MANAGEMENT - PARKING AND WAITING RESTRICTIONS** (Pages 47 - 70)
10. **PARKING AND WAITING RESTRICTIONS - UPDATE SUMMARY** (Pages 71 - 78)

Item
No

Subject

11. **PARKING PLACES FOR DISABLED PERSONS VEHICLES** (Pages 79 - 84)

12. **DATE OF NEXT MEETING**

The next meeting of the Board will be held at 7.00 pm on Wednesday, 19 March 2015.

JOINT TRANSPORTATION BOARD

Minutes of the meeting held on 18 September 2014 at 7.00 pm in Council Chamber, Cecil Street, Margate, Kent.

Present: Councillor Roger Latchford OBE (Chairman); Councillors Clark (Thanet District Council), Aldred (Thanet District Council), K Gregory (Thanet District Council), S Hart (Thanet District Council), D Saunders (Thanet District Council), M Saunders (Thanet District Council), J Scobie (Thanet District Council), J Elenor (Kent County Council - Margate West), W Scobie (Kent County Council - Margate and Cliftonville Electoral Division), Shonk (Kent County Council - Ramsgate), Terry (Kent County Council - Broadstairs and Sir Moses Montefiore) and Wiltshire (Kent County Council - Broadstairs and Sir Moses Montefiore Electoral Division)

In Attendance: Councillors C Hart and H Scobie (Thanet District Council)
Mr David Brazier, Cabinet Member for Environment and Transport, Kent County Council
Paul Valek, District Manager, Kent County Council Highways and Transportation
Nina Peak, Partnership Manager, Southeastern Railway
Kerry Prescott, Team Leader, Transport Innovations, Kent County Council
Robin Chantrill-Smith, Civil Enforcement Manager, Thanet District Council

WELCOME TO MR DAVID BRAZIER

The Chairman welcomed Mr David Brazier, Cabinet Member for Environment and Transportation, Kent County Council, to the meeting.

NOTIFICATION OF PETITIONS RECEIVED BY KENT COUNTY COUNCIL, HIGHWAYS AND TRANSPORTATION

It was NOTED from Paul that, since the previous meeting of the Board, petitions had been received by Kent County Council, Highways and Transportation, as follows:

Subject of petition	Update
Street lighting, Cedar Close, Broadstairs	<i>Response to go out within the next few days</i>
Widening of pavement outside Doctors' Surgery, Union row, Margate	<i>Response to go out the following day</i>
Street lighting, Highfield's Gardens, Margate	<i>Response to go out in the near future</i>
Installation of a roundabout at Poorhole Lane / Star Lane / Ramsgate Road – reduced parking space outside of shop	<i>Response sent 15 September 2014</i>
Dispute with a neighbour being granted permission for a vehicle crossing, Giles Gardens, Margate	<i>Response sent 26 August 2014</i>

Implementation of yellow lines in Approach Road, Margate *Petition passed to Thanet District Council, 3 September 2014*

8. APOLOGIES FOR ABSENCE

Apologies for absence were received from Mrs Mo Elenor, Mr Heale and Councillor Savage.

9. DECLARATIONS OF INTEREST

There were no declarations of interests.

10. MINUTES OF PREVIOUS MEETING

It was proposed by Mrs Wiltshire, seconded by Councillor K Gregory, and AGREED that the minutes of the meeting held on 12 June 2014 be approved and signed by the Chairman.

11. HIGHWAY WORKS PROGRAMME 2014/15

Paul Valek, District Manager, Kent County Council Highways and Transportation, provided verbal updates as follows:

Micro Asphalt Schemes

SCHEMES NOW COMPLETED: Radley Close, Broadstairs; Dumpton Lane, Ramsgate; and Albion Road, Broadstairs

Machine Resurfacing

SCHEMES NOW COMPLETED: A28 Canterbury Road, St Nicholas-at-Wade; School Lane, Ramsgate
SCHEME TO BE COMMENCED SHORTLY: A256 Westwood Road/Northwood Road roundabout
SCHEMES AWAITING PROGRAMME DATES: Northdown Park Road, Margate; A299/A253 Monkton Roundabout

Drainage Repairs & Improvements

Several drainage sites in Thanet were currently being investigated with a view to identifying works required.

Street Lighting

In response to a query from Councillor S Hart, Paul Valek undertook to find out why Millmead Road was on hold and report back to Councillor Hart direct.

Local Transport Plan Funded Schemes

Sandwich Road, Cliffsend, Phase 2 – work to commence, 29 September 2014

Member Highway Fund

In answer to a query from Mr W Scobie, Paul Valek said he would make enquiries as to when the zebra crossing at **Northumberland Avenue, Cliftonville** would be installed.

It was NOTED from Mr Terry that the bus shelter at **Westwood Road, Broadstairs** had now been installed.

The Highway Works Programme was NOTED.

12. TRAFFIC MANAGEMENT - PARKING AND WAITING RESTRICTIONS

It was proposed by Councillor K Gregory, seconded by Councillor D Saunders and AGREED:

1. THAT the recommendations shown at Annex 1 be approved;
2. THAT the proposals which require statutory consultation be advertised and that any traffic related objections be reported back to a future meeting of the Board.

13. PARKING AND WAITING RESTRICTIONS - UPDATE SUMMARY

Queries were raised by Members regarding the status quo of the following schemes:

Location	Update by Robin Chantrill-Smith
Green Lane, Broadstairs	No objections received; about to go live
Farley Road, Margate	No objections received; about to go live
Canterbury Road West	This scheme includes Seaview Road

The report and updates were NOTED.

14. PARKING PLACES FOR DISABLED PERSONS VEHICLES - THANET

It was proposed by Mrs Wiltshire, seconded by Councillor K Gregory, and AGREED:

1. THAT the parking places for disabled persons' vehicles as listed in Annex 1 be exposed for formal public consultation;
2. THAT the proposals which require statutory consultation be advertised and that any traffic related objections be reported back to a future meeting of the Board.

15. SUMMARY OF STORM AND FLOOD ISSUES

Vote of Thanks

A vote of thanks, proposed by Mr W Scobie and seconded by Councillor Hart, was extended to the Thanet district staff at Kent Highways and Transportation for their valuable contribution during the storms of 2013/2014.

The report to the Environment & Transport Cabinet Committee, Kent County Council, was NOTED.

16. MARGATE RAILWAY STATION FORECOURT ENHANCEMENT UPDATE AND RAMSGATE RAILWAY STATION - FORECOURT ENHANCEMENT CONSULTATION RESULTS - LOCAL SUSTAINABLE TRANSPORT FUND

Kerry Prescott, Team Leader, Transport Innovations, Kent County Council, presented the report and Nina Peak, Partnership Manager, Southeastern Railway, outlined the key features of the Margate & Ramsgate station forecourt enhancement schemes (as illustrated at Annexes 1 & 2 to the report).

In response to comments and queries from Members, Nina stated that:

1. she would have a look at the arrow at Ramsgate station which purportedly misdirected cars to the lane to the left rather than the lane to the right;
2. it was hoped to commence works at Ramsgate station by the end of January 2015;
3. the Margate scheme should be completed within the next couple of weeks; a map showing key places of interest and walking times would be placed on a plinth outside of the station.

It was proposed by Mrs Wiltshire, seconded by Mr Terry and AGREED:

“THAT the report be noted and the progression to construction for the Ramsgate Forecourt scheme endorsed”.

17. MANSTON COURT ROAD

The report was NOTED.

18. DATE OF NEXT MEETING

It was NOTED that the next meeting of the Board would be held at 7.00 pm on Tuesday, 16 December 2014.

REMARKS BY MR DAVID BRAZIER, CABINET MEMBER FOR ENVIRONMENT AND TRANSPORTATION, KENT COUNTY COUNCIL

Before concluding the meeting, the Chairman asked Mr Brazier if he would like to say a few words. Mr Brazier replied by stating that he had enjoyed the meeting, which he felt had been most constructive and harmonious.

Meeting concluded : 7.45 pm

MARGATE MARKET – PROPOSED RELOCATION TO CECIL SQUARE

To: **Thanet Joint Transportation Board – 16 December 2014**

By: **Community Regeneration Officer**

Classification: **Unrestricted.**

Ward: **Margate Central**

Summary:

The report presents the intention to relocate the weekly Margate market from the High Street to Cecil Square. This will involve restricting traffic on market day with provision for taxis. The rest of the time the area outside the NatWest Bank will become pay and display bays with motorcycle parking, instead of double yellow lines and a loading/unloading bay.

For Information and comment

1. Introduction and Background

- 1.1 Thanet District Council wants to move Margate market to a permanent authorised site in Cecil Square. The market is a general market held every Wednesday in the Upper High Street. For the last decade, Margate Town Partnership has had the responsibility for Margate market and they moved it to its current location without the required agreement from Kent Highways and without planning consent. Kent County Council (KCC) Highways have indicated that they would support a permanent formal home for the market in Cecil Square.
- 1.2 Since the market moved into the upper High Street, the shop-keepers have expressed disquiet about stalls blocking their frontages. As the number of vacant shops in the High Street has reduced, the number of places where stalls can be erected without seriously blocking shop windows and/or the street has declined. The market now runs sporadically along the upper High Street including occasionally spilling onto the pavement near the pedestrian crossing. This lack of space and the instability as stalls move to fit around re-opening shops means the market is struggling.
- 1.3 In recognition of the important role flourishing markets have in supporting High Streets Thanet District Council has decided to undertake the processes required to relocate Margate market to Cecil Square, where it will have the space to expand while still supporting the footfall within the town centre. The Council has received a positive response from KCC Highways to this proposal, subject to the TRO and planning permission, and a consultant, Roger Casement, has been appointed to carry out the Traffic Regulation Order (TRO).
- 1.4 The TRO seeks to restrict traffic one day a week with provision for taxis to enable the weekly Wednesday Margate market to be held in Cecil Square. The TRO will run from 6am to 6pm on every Wednesday. The taxi rank will be officially moved to outside NatWest Bank on market days. The rest of the time the area outside the NatWest Bank will become pay and display bays with motorcycle parking, instead of double yellow lines and a loading/unloading bay. This will increase income and reduce illegal parking.

1.5 This report is for the board's information and comment.

2. Options available: N/A

3. Corporate Implications

3.1 Financial

3.1.1 Moving Margate Market to Cecil Square for one day per week will result in a potential loss of approximately £9.1K p.a. to the on-street parking income. It is expected that this will be mainly (if not fully) mitigated by an agreement between the Council and the market operator. The anticipation is that the combination of a better location and the agreement (which would include quality and growth objectives) would result in the market growing and further offsetting the parking revenue loss. In addition the extra parking bays being installed in the TRO process will also mitigate the potential loss in parking income. There is also potential that at least some of the parking revenue would be offset by customers parking elsewhere in the town centre.

3.1.2 Business Rates and Public Liability costs will be incorporated into the operator agreement so that the Council is not put at risk in these respects.

3.1.3 Traffic barriers will need to be organised on market day to control the vehicular access to the square, which will involve barriers being placed out at 06.00hrs and collected at 16.00hrs. This will be covered by the operator.

3.1.4 No additional staffing resources are proposed, as the majority of the controls should be self-enforcing.

4.2 Legal

4.2.1 Officers will work with the legal team to ensure a smooth transfer of the market to Cecil square and the Council's responsibility. Appropriate legal agreements will be put in place to optimise the impact of the market on the development of the town and minimise risks to the Council. It is intended to utilise national best practice legal template advice from national Association of British Market Authorities (NABMA).

5.3 Corporate

5.3.1 This relocation is in line with the Council's Corporate Plan Priority 1 supporting the growth of our economy and the number of people in work, Priority 3 supporting community and voluntary organisations (Margate Town Team objectives in improving Margate Town Centre) and Priority 5 by overcoming the currently unacceptable location in Highway terms. Parking is adversely affected on market day, but improved on the other 6 days).

6.4 Equity and Equalities

6.4.1 The market is intended to be available to all residents and visitors to the town, and the proposed new Margate location would be fully accessible to all. Efforts will be made to encourage a wider appeal than at present for Margate Market. Due to the availability of the market for all, an Equality Impact Assessment is not considered relevant and therefore has not been carried out.

7.0 Recommendations: N/A

8.0 Decision Making Process: N/A

Contact Officer:	<i>K Wilson (Civil Enforcement Manager) 01843 577037</i>
Reporting to:	<i>L Askew (Economic Development Manager) 01843 577178</i>

Background Papers None

<i>Annex List</i>	
<i>Annex 1</i>	<i>Plan of Cecil Square</i>

This page is intentionally left blank

Annex 1: Proposed layout: Cecil Square, Margate.

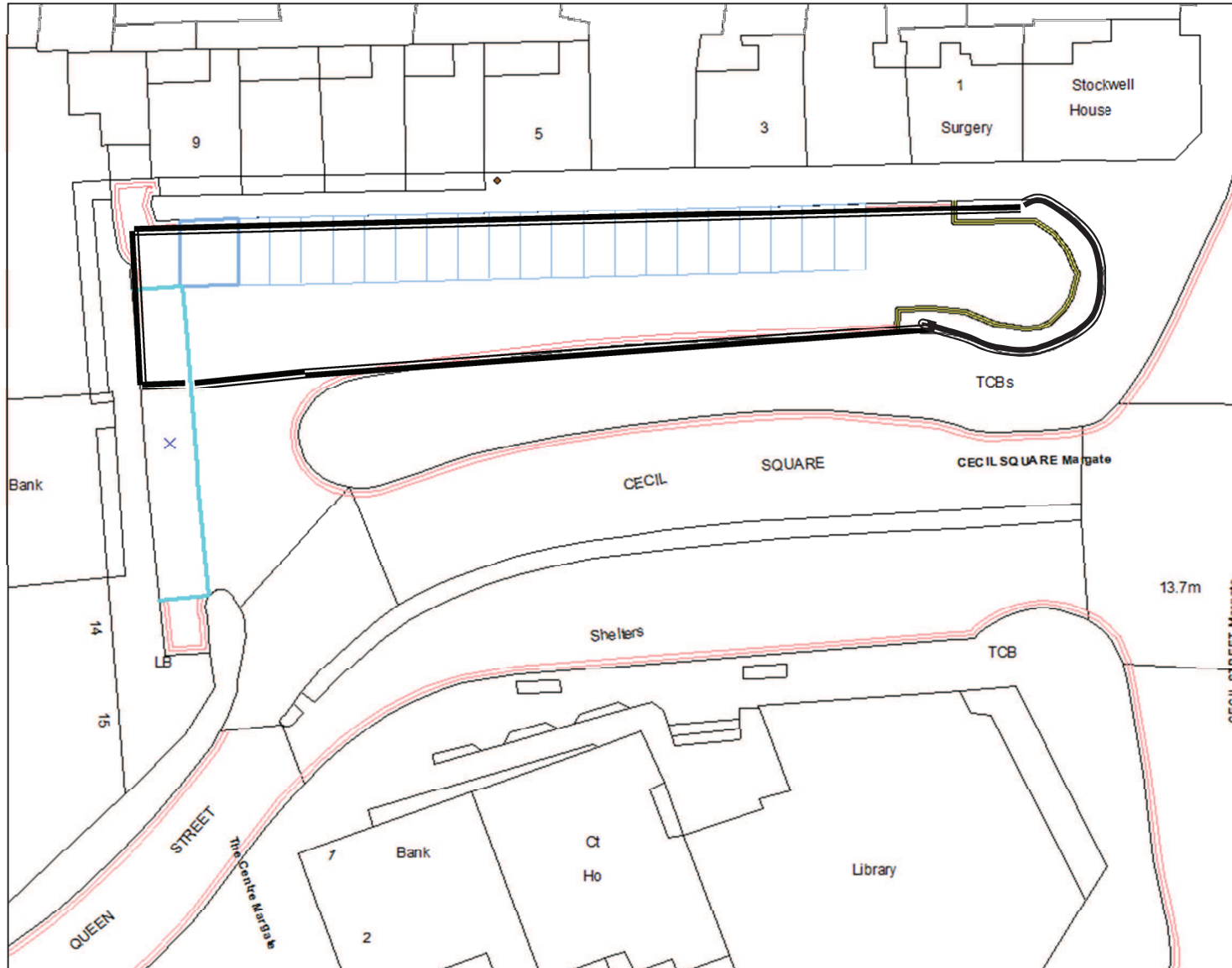

Proposed pay & display bays to replace loading bay and yellow lines.

Proposed market space



Proposed layout:
Cecil Square,
Margate

SLI 100018261

This page is intentionally left blank

Thanet Parkway Railway Station – A key infrastructure project for East Kent

To: Thanet Joint Transportation Board – 16 December 2014

By: Paul Crick, Director of Environment, Planning and Enforcement KCC

Classification: Unrestricted

Ward: Minster and Cliffsend & Pegwell

Summary: This report is for information only. Kent County Council is proposing a new Parkway station on the existing railway line between Minster and Ramsgate stations, situated just to the west of the village of Cliffsend in Thanet. This station is critically required to improve rail access to Manston Airport site, business parks around Westwood and Discovery Park Enterprise Zone to support existing and new development in Thanet and Dover.

For Information

1.0 Introduction

- 1.1 Kent County Council (KCC) has for a number of years had an aspiration to deliver a parkway station and associated car park in Thanet to operate as a park and ride facility. A Parkway station, in conjunction with the rail journey time improvements being implemented between Ashford and Ramsgate, will boost inward investment in Thanet and Dover by making them a more attractive location to do business. The connection to London in around an hour as well as the expanded employment catchment area for Thanet and Dover residents will provide a significant economic boost to East Kent.
- 1.2 Providing a Parkway Station is also a component of KCC's statutory Local Transport Plan (2011-16), the Council's 20 year transport delivery plan, Growth without Gridlock (2010-30) and Kent Rail Action Plan (2011).
- 1.3 KCC Environment & Transport Cabinet Committee in July 2014 made recommendations to the Cabinet Member for Environment & Transport on a decision to undertake public consultations and scheme development work, and acquire land in order to take forward the delivery of the Parkway Station, scheduled for completion in the financial year 2018/19.
- 1.4 Technical work has shown that the optimal location of the Parkway station is to the south of Manston Airport site and just to the west of the village of Cliffsend on the Ashford-Ramsgate rail line, and with direct access to the East Kent Access road, as shown in Figure 1 below. The following key elements were considered in selecting the optimal location of the station:
 - Railway operation – signalling, curvature, gradient, level crossing/bridge locations, timetabling
 - Station design
 - Access to road network and
 - Potential property disturbance.

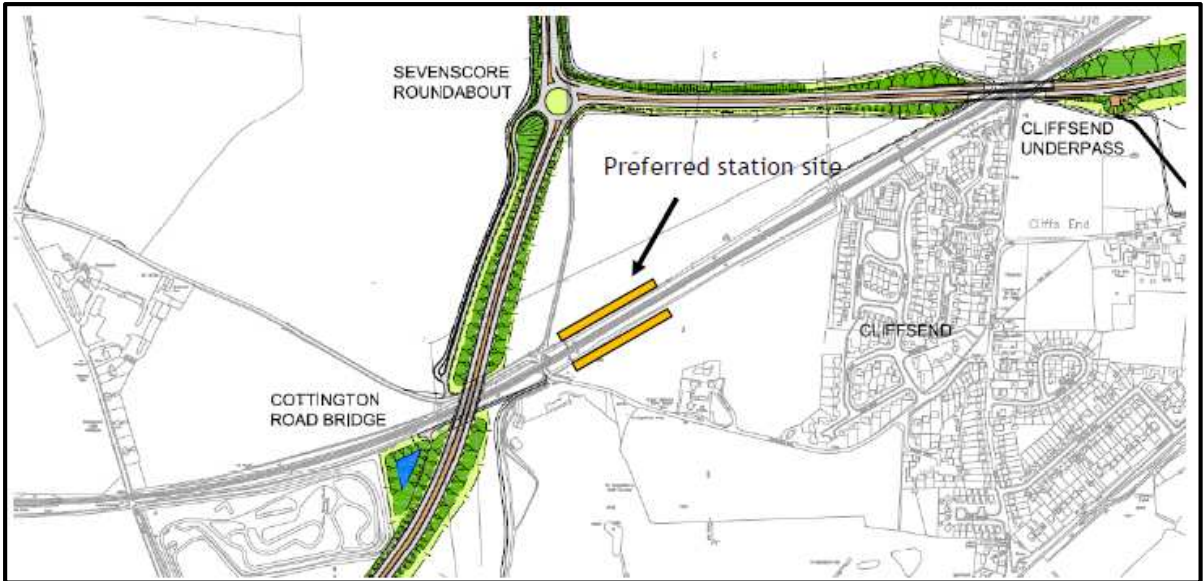

Figure 1: Thanet Parkway proposed location

1.5 The project's objective is to support development at Manston Airport site, business parks around Westwood and Discovery Park Enterprise Zone (shown in Figure 2 below). The following outcomes are expected from the delivery of the station:

- increased inward investment in Thanet and Dover
- thriving Enterprise Zone and surrounding business parks
- greater employment opportunities for Thanet and Dover residents
- access to high speed rail services across district.

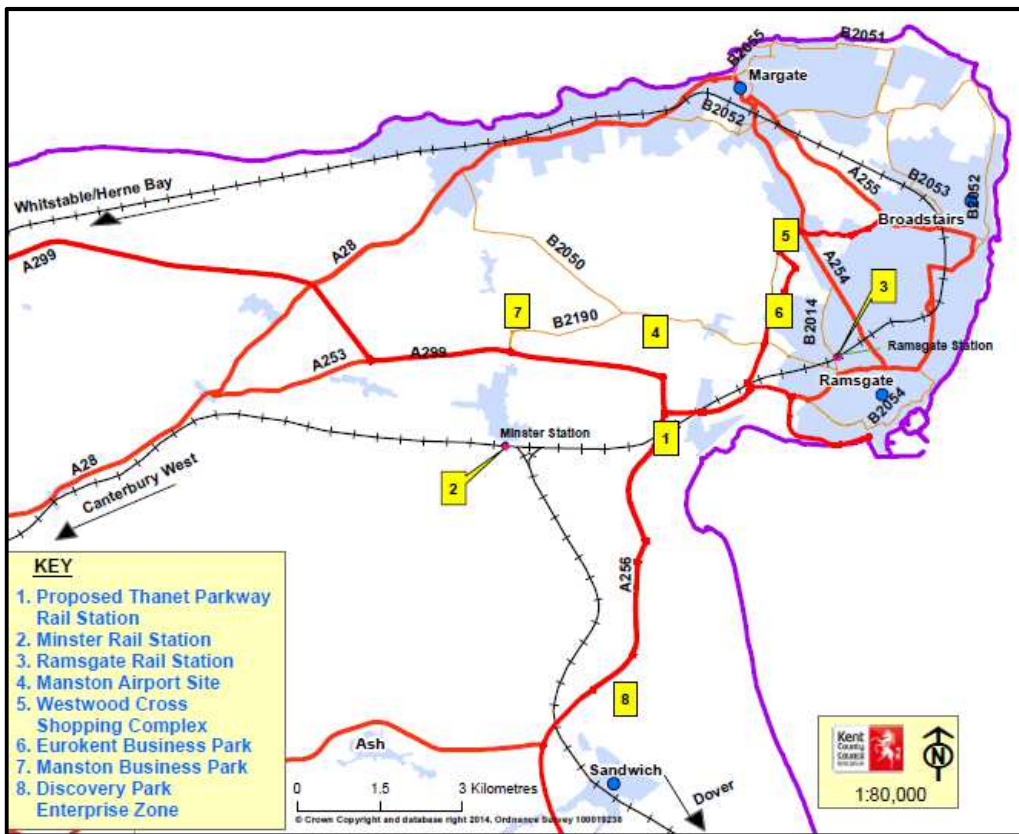

Figure 2: Thanet Parkway and Development in the area

2.0 Draft Station Specification

2.1 The Parkway station will consist of the following elements which are subject to discussions with Network Rail and the Train Operating Company, Southeastern:

- Two station platforms with disabled access
- Disabled access ramps/lifts with footbridge
- Ticket vending machine, waiting area and journey information point
- CCTV and passenger help points
- Car park and associated facilities with disabled access to platforms
- Drop off/ pick up point for buses, taxis and cars
- Access to the new East Kent Access Road and
- Pedestrian and cycle access.

3.0 Draft Business Case

3.1 The cost estimated for the proposed Parkway station is £14 million. In July 2014 KCC secured £10 million of funding from Government through the South East Local Enterprise Partnership. £2.65 million is being provided by the KCC. Options to fill the £1.35 million funding gap are being explored with Network Rail and the private sector.

3.2 The draft business case (March 2014) concludes that the proposed Parkway station offers an excellent return on the investment indicating that for every £1 of investment made there will be more than £2.12 worth of benefits generated over the 60 years appraisal period. The commercial analysis shows that the station is viable with net generated fares income significantly exceeding the operating and maintenance costs.

3.3 The demand analysis shows that the station would require a car park with 137 spaces initially, rising to 248 after 30 years, although there is ample land immediately surrounding the station site for further expansion if such additional need arises. However, it should be noted that the business case takes into account committed development only; therefore further development such as further expansion at the Enterprise Zone as well as any development of the airport site have not been included in our assessment.

3.4 Furthermore, given the uncertainty around Manston Airport during March 2014, the business case analysis does not include any activity at the airport site based on the Department for Transport's modelling and appraisal guidance. This could therefore be considered a worst case scenario and any future activity at the airport site will further boost the case for a parkway station.

3.5 The demand Thanet Parkway will generate over time is estimated under the scenarios of the car parking being charged and not charged. Table 1 below shows that for example in 2021 with parking charged there will be a total of 106,000 trips annually at the Parkway station of which just over 40,000 are new trips and just under 66,000 abstracted trips from other stations. With no parking charge the figure would be 123,147 trips annually at the Parkway.

Table 1: Thanet Parkway Annual Demand Breakdown

Thanet Parkway Demand Breakdown	Annual Demand 2021 With Parking Charge	Annual Demand 2021 No Parking Charge	Annual Demand 2031 With Parking Charge	Annual Demand 2031 No Parking Charge
To London – Abstracted	29,298	36,098	31,396	38,811
To London –New	14,686	15,916	15,916	17,146
To Other – Abstracted	36,849	43,972	39,597	47,588
To Other – New	25,534	27,161	27,776	29,150
Abstracted – Total	65,894	80,070	70,993	86,399
New – Total	40,220	43,077	43,439	46,549
TOTAL TRIPS	106,114	123,147	114,432	132,948

- 3.6 In terms of where the abstracted trips come from, Tables 2 and 3 below provide a breakdown of the total abstracted demand from existing stations (Ramsgate, Minster, Sandwich, Margate and Broadstairs). None of the other stations in Thanet and Dover will see any abstraction. The “lost” trips are those that no longer choose to travel by train at all which may be due to the slightly increased journey time to Ramsgate.

Table 2: Abstracted Trips with Parking Charge at Thanet Parkway (2021)

Existing Stations	Abstracted Demand	Lost Demand	Total	Trips with Thanet Parkway Operational	% Reduction in Trips
Ramsgate	46,094	15,155	61,249	393,357	15.35%
Minster	3,893	-	3,893	26,092	12.98%
Sandwich	15,960	-	15,960	127,370	12.53%
Margate	665	3,626	4,291	180,240	2.38%
Broadstairs	1,224	2,709	3,933	143,655	2.78%

Table 3: Abstracted Trips with No Parking Charge at Thanet Parkway (2021)

Existing Stations	Abstracted Demand	Lost Demand	Total	Trips with Thanet Parkway Operational	% Reduction in Trips
Ramsgate	58,200	14,749	72,949	381,250	16.06%
Minster	3,893	-	3,893	26,092	12.98%
Sandwich	18,054	-	18,054	125,274	14.41%
Margate	665	3,626	4,291	180,240	2.38%
Broadstairs	1,224	2,709	3,933	143,655	2.78%

- 3.7 While the tables above show that there is abstraction across all the stations within reasonable distance of Thanet Parkway, they also demonstrate that after abstraction there is still an addition of over 40,000 new rail trips on the network in 2021 with the Parkway in operation. Discussions with Southeastern and Network Rail provide reassurance that the future of railway services calling at stations in Dover and Thanet would not be in doubt as a result of the operation of Thanet Parkway.

4.0 Stakeholders’ Support

- 4.1 KCC are working in partnership with Network Rail to deliver a 10-minute planned journey time improvement scheme on the existing line between Ashford International and Ramsgate Railway stations, which will more than mitigate the time delay of adding the new station to the line providing an overall benefit to those travelling to Ramsgate. The £11.8 million funding for this project is committed by the Department for Business, Innovation and Skills (£5 million) and Network Rail (£6.8 million). The first phase (Ashford-Canterbury West) and second phase (Canterbury West-Ramsgate) will be completed during the financial years of 2016/17 and 2018/19 respectively.
- 4.2 The Journey Time Improvement and Thanet Parkway Railway station projects will enable KCC to achieve its aspiration of bringing Thanet/Discovery Park within an hour journey time of London Stratford, improving perceptions of East Kent for inward investment and raising employment levels through improved accessibility to the wider job market.
- 4.3 A Project Board for Thanet Parkway station was established in January this year, which meets quarterly, and is attended by the Department for Transport, KCC Cabinet Member for Environment and Transport, Network Rail, Southeastern, Dover and Thanet District Councils, Design Consultants and KCC Property and Finance teams.
- 4.4 The Department for Transport, Network Rail and Southeastern are supportive of the Parkway station in principle and are working closely with the KCC project team as we progress towards delivery of this project.
- 4.5 The Parkway station was presented to Thanet District Council's Cabinet (29th May 2014), Dover District Council at their Full Council meeting (23rd July 2014) and businesses at Discovery Park Enterprise Zone (16th July 2014). Positive feedback on the Parkway project was received in these meetings.
- 4.6 KCC are currently engaging with the Parish and Town Councils of Thanet and Dover to introduce the Parkway project. A presentation was given to St. Nicholas-at-Wade with Sarre Parish Council at the Parish Council Meeting on Tuesday 11th November, at which the project was positively received. A copy of the PowerPoint presentation was sent to Sandwich and Broadstairs & St Peters Town Councils. Meetings will also be taking place with:
- Minster Parish Council, Tuesday 2nd December
 - Cliffsend Parish Council, Friday 12th December
 - Ramsgate Town Council, Monday 15th December.
- 4.7 A paper on the Parkway station has been submitted for information for the Dover Joint Transportation Board meeting on the 11th of December.
- 4.8 The Parkway project has also gained the wider support from other key stakeholders: Kent and Medway Economic Partnership, Kent Economic Forum Business Advisory Board and Locate in Kent.

5.0 Options Considered

- 5.1 A range of options were considered by stakeholders and KCC officers to improve rail connectivity to the Manston Airport site, Discovery Park and development sites in Thanet. The following options were considered:
- New Parkway Railway Station
 - Increase car parking provision at existing Ramsgate Railway Station
 - Increase car parking provision at existing Minster Railway Station
 - Shuttle bus from the existing Birchington-On-Sea Railway Station
 - Direct coach service between London and Manston Airport site/ Discovery Park

- Shuttle bus from existing Ramsgate Railway Station.
- 5.2 Increasing car park provision at Ramsgate station and delivering a new Parkway station were shortlisted for further analysis.
- 5.3 Ramsgate station currently has 44 parking spaces, including 2 accessible spaces. A large number of those currently driving to the station do not use the car park due to lack of space, but park on residential streets around the station where there are currently no restrictions.
- 5.4 It is known that development of a car park at Ramsgate is likely to be a short term solution in view of the potential growth arising from Thanet Local Plan, as well as land and viability issues associated with delivering a car park for 300 spaces. The following four options were initially identified and investigated, however all have major issues affecting delivery:
- Decking the existing station car park;
 - Building a multi storey car park at the Network Rail Maintenance Depot;
 - Building a car park at Warre Recreation Ground; and
 - Acquiring industrial land on Prince's Road to construct a car park.
- 5.5 These options were found not to be viable, as they would increase congestion, safety and pollution in the immediate residential area, as well as potentially affecting privacy and well-being of residents in Ramsgate. Further explanation of these options can be found in Annex 1.

6.0 Thanet Parkway Project Impacts and Opportunities

- 6.1 As a typical transport infrastructure project, the Parkway Station will have impacts and opportunities for the local and wider communities in Thanet and Dover. Table 4 below presents a summary of potential impacts perceived by stakeholders and how these impacts will be dealt with in developing the project.

Table 4: Potential Impacts of the Parkway Station

Impact	KCC consideration
Services Calling at other local stations in Thanet and Dover	The demand analysis has shown that whilst there may be a reduction of passenger usage of some local stations, Thanet Parkway will not result in closure or loss of service to these stations, including Minster. These stations are specified in the rail franchise agreement between the Department for Transport and Southeastern.
Additional journey time to Ramsgate Station	The two minute delay on journeys to/from Ramsgate will be offset by the planned 10 minutes Journey Time Improvements on this line, thus the addition of the parkway station will not lead to an increased journey time to/from Ramsgate Station.
Ramsgate Station Forecourt Improvement Scheme	The Thanet Parkway project will not affect Southeastern's Forecourt Improvement scheme at Ramsgate Station. The scheme is progressing, and detailed design drawings have now been completed taking into account the comments which arose from the consultation period. Construction is likely to begin early in 2015 following a tender process in December 2014. A plan for the works is attached as Annex 2.

The Environment	A full Environmental Impact Assessment will be conducted to understand the impact of this development. The appropriate mitigation measures will be incorporated in the design work.
Congestion	The station will have access to the newly built East Kent Access Road which has ample capacity to accommodate future growth. A Transport Assessment will be produced as part of the planning application. The Parkway station will reduce congestion around residential area in Ramsgate as a result of fewer trips to Minster, Sandwich and Ramsgate stations.

6.2 The Parkway station will provide a number of opportunities to the local communities and businesses in Dover and Thanet as shown in Figure 3 below.

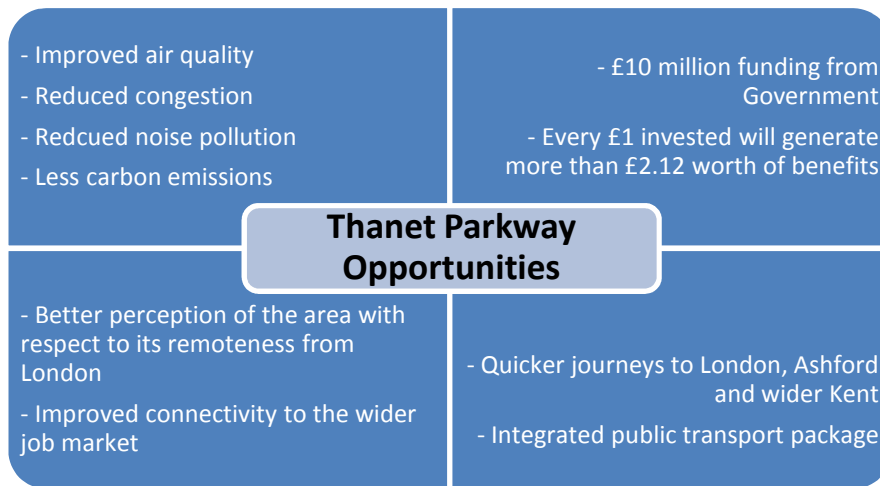

Figure 3: Thanet Parkway Opportunities

7.0 Current Project Status

- 7.1 KCC has recently commissioned URS consultants to produce an outline design and a planning application, including Environmental Impact Assessment, and undertake the first public consultation.
- 7.2 KCC has signed a Basic Asset Protection Agreement (BAPA) with Network Rail allowing Network Rail to review the project design and enabling access to their asset for site visits and surveys.
- 7.3 The ownership and operation of the station car park is being reviewed by URS consultants, which will have an impact on the station operating cost and identify who the determining Planning Authority would be under each of these options.
- 7.4 KCC has opened discussions with the two land owners to discuss the purchase of the land for the delivery of Thanet Parkway station (including car park and access road from the East Kent Access Road).

8.0 First Public Consultation and Future Steps

- 8.1 The aim of the first public consultation is to have early engagement with the public and stakeholders to get their views on developing the station, and share information on project background and impact/opportunities.
- 8.2 A Consultation and Communication Strategy has been developed and a dedicated web page is being established on KCC website for Thanet Parkway station project.

8.3 The consultation will take place in week commencing 2nd February 2015 for a period of 8 weeks. Meetings with parish councils and community groups in Thanet and Dover, bus and taxi operating companies are being arranged.

Table 5: First Public Consultation Arrangements

Location – Public Events	Date & Time
Ramsgate Town Hall	Saturday 21 st February 2015 (10:00 – 18:00)
Ramsgate Railway Station	Weekday tbc (w/c 16th February 2015) (15:00 – 19:30)
Sandwich Guildhall	Thursday 19 th February 2015 (12:00 – 20:00)
Cliffsend Village Hall	Thursday 12 th February 2015 (12:00 – 20:00)
Discovery Park Enterprise Zone	Weekday tbc (w/c 23rd February) (10:00 – 18:00)

8.4 The next steps following the first public consultation are given below:

- Complete outline design (Aug 2015)
- Second public consultation (Jan 2016)
- Submit planning application (May 2016)
- Complete detailed design (Sep 2017)
- Start construction (Dec 2017)
- Station ready for service (Jan 2019).

9.0 Recommendation(s)

9.1 Members are asked to note this report for their information.

Contact Officer KCC:	Ann Carruthers – Head of Strategic Planning and Policy Ann.Carruthers@kent.gov.uk
Reporting to:	Paul Crick – Director of Environment, Planning and Enforcement KCC

Annex List

<i>Annex 1</i>	Increased Car Park at Ramsgate Station Option
<i>Annex 2</i>	Ramsgate Forecourt Improvement Scheme Plan

Background Papers

Title	Details of where to access copy

16 December 2014 Thanet JTB
 Thanet Parkway Railway Station – A key infrastructure project for East Kent
 Annex 1: Increased Car Park Provision at Ramsgate Station Option

Option	Discussion	Location
<p>Decking the existing car park at Ramsgate Station</p>	<p>Option would require more traffic to be routed through the residential area, increasing congestion, noise and pollution. The privacy of residents would also be impacted during construction. The estimated cost would be £6-10 million for what would be considered a short-medium term fix.</p>	
<p>Building a multi storey car park at the Network Rail Maintenance Depot</p>	<p>Option would require Network Rail to still maintain their current parking, security and HGV access to the site during construction and operation, increasing the estimated cost of the scheme to £7-10 million. The depot is also a 7-10 minute walk from the station making this option less attractive to rail users</p>	

16 December 2014 Thanet JTB
Thanet Parkway Railway Station – A key infrastructure project for East Kent
Annex 1: Increased Car Park Provision at Ramsgate Station Option

		
<p>Building a car park at Warre Recreation Ground</p>	<p>This option would lead to irreversible loss of green space in Ramsgate and thus would likely lack public support.</p>	

16 December 2014 Thanet JTB
 Thanet Parkway Railway Station – A key infrastructure project for East Kent
 Annex 1: Increased Car Park Provision at Ramsgate Station Option

<p>Acquiring industrial land on Prince's Road to construct a car park</p>	<p>It was considered to acquire a new plot of land off the Prince's Road. The area totals 3.638 acres. There are eight freehold titles on the land held in six ownerships.</p> <p>The only vacant site is 0.46 acres in size. The provision of 300 parking spaces at street level might require between 1.98-2.97 acres depending on design, access and planning requirements and is thus not feasible. A multi-storey car park could be an option, but this requires land up to 0.74 acres.</p> <p>The seven other sites are all in use, five of which are operational businesses and two are warehouses and storage. The land is valued at £6.8 million and with £5 million estimated construction costs; this option would be expensive as a short-medium term option.</p> <p>This option would also lead to increased traffic and congestion in the residential area. Privacy and well-being of residents would be impacted and there would be a loss of industrial floor space and jobs.</p>	

This page is intentionally left blank

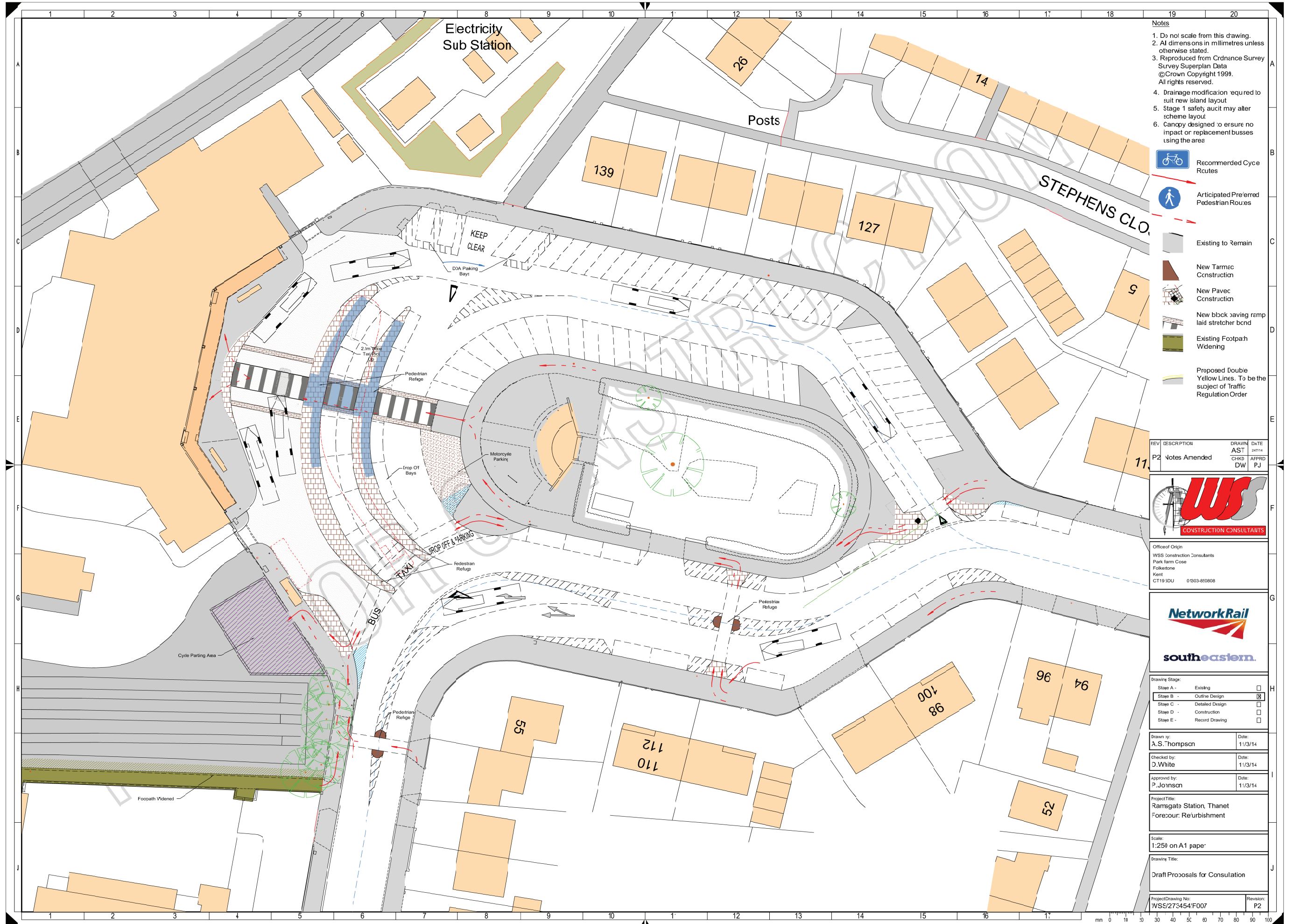

- Notes
1. Do not scale from this drawing.
 2. All dimensions in millimetres unless otherwise stated.
 3. Reproduced from Ordnance Survey Survey Superplan Data © Crown Copyright 1999. All rights reserved.
 4. Drainage modification required to suit new island layout.
 5. Stage 1 safety audit may alter scheme layout.
 6. Canopy designed to ensure no impact on replacement buses using the area.

- Recommended Cycle Routes
- Anticipated Preferred Pedestrian Routes
- Existing to Remain
- New Tarmac Construction
- New Pavement Construction
- New block paving ramp laid stretcher bond
- Existing Footpath Widening
- Proposed Double Yellow Lines. To be the subject of Traffic Regulation Order

REV	DESCRIPTION	DRAWN	DATE
P2	Notes Amended	AST	28/1/14
		CHKD	APPRD
		DW	PJ



Office of Origin
WSS Construction Consultants
Park Farm Close
Folkestone
Kent
CT19 3DU 01303-80808



Stage A - Existing	<input type="checkbox"/>
Stage B - Outline Design	<input checked="" type="checkbox"/>
Stage C - Detailed Design	<input type="checkbox"/>
Stage D - Construction	<input type="checkbox"/>
Stage E - Record Drawing	<input type="checkbox"/>

Drawn by: A.S. Thompson	Date: 11/3/14
Checked by: D. White	Date: 11/3/14
Approved by: P. Johnson	Date: 11/3/14

Project Title:
Ramsgate Station, Thanet Forecourt Reurbishment

Scale:
1:250 on A1 paper

Drawing Title:
Draft Proposals for Consultation

Project Drawing No: WSS/273454/F007	Revision: P2
--	-----------------

This page is intentionally left blank

From: John Burr, Director of- Highways & Transportation

To: Thanet Joint Transportation Board

Date: 16 December 2014

Subject: Minster Section 106 Spend

Classification: Unrestricted

Summary: Report on Minster Section 106 spend from Heronsbrook development on High Street and Monkton Road, Minster.

For Decision

Heronsbrook Section 106 Spend

Introduction

The Heronsbrook development at Minster (Monkton Road – 100 units)secured a highway contribution of £180,000 for highway improvements and £5,000 for bus stop improvement/relocation. The £180,000 was for traffic calming measures associated with the increase in demand created by the development.

KCC Highways has been liaising with the Parish Council to determine where the worst impacts in the Village are occurring as a result of increased traffic movements and looking at measures to address such impacts.

Following works approved to the Butts Estate the Parish Council next wanted to address the traffic congestion and highway safety issues surrounding Monkton Road and High street.

Monkton Road – The Parish have for many years complained that the footway which was put in by KCC on Monkton Road between Tothill Street and Egbert Road is too wide and creates blockages on this section of carriageway. On street parking opposite the path and the path itself leaves a reduced width of carriageway to allow traffic to flow freely and poses particular problems for buses and large vehicles with significant delays occurring at peak times.

A scheme has been drawn up which reduces the footway width to 1.5m and introduces some double yellow lines to create passing places for longer vehicles. This proposal should keep traffic flowing freely through this section of Monkton Road.

High Street - The footway in the High Street is extremely substandard in width, narrowing down in places to less than 0.5m. When cars park kerbside this forces

pedestrians with pushchairs or wheelchairs out into the carriageway without any safeguarding from vehicles also using the High Street.

The proposal is to increase the width of the footway to a minimum of 1.2m and to introduce double yellow lines to regulate kerbside parking. Parking is retained where appropriate but such measures will create adequate passing places at a minimum of 40m intervals. This will enable a safe environment for pedestrians and formalise sections a “single way working” for sections of the High Street with the creation of passing areas long enough to accommodate buses.

Critical Aspects

Any TRO's would be subject to a public consultation.

Finance

All costs will be from the Section 106 Funding

Recommendations

That works will progress as per the proposals outlined above.

FOR INFORMATION

Background Documents

Plans attached – KCC/S106/MHS/001 Rev.B
KCC/S106/MHS/002 Rev. A

Contact details

Sally Benge – Strategic Transport & Development Planner
Sally.benge@kent.gov.uk
03000 418181

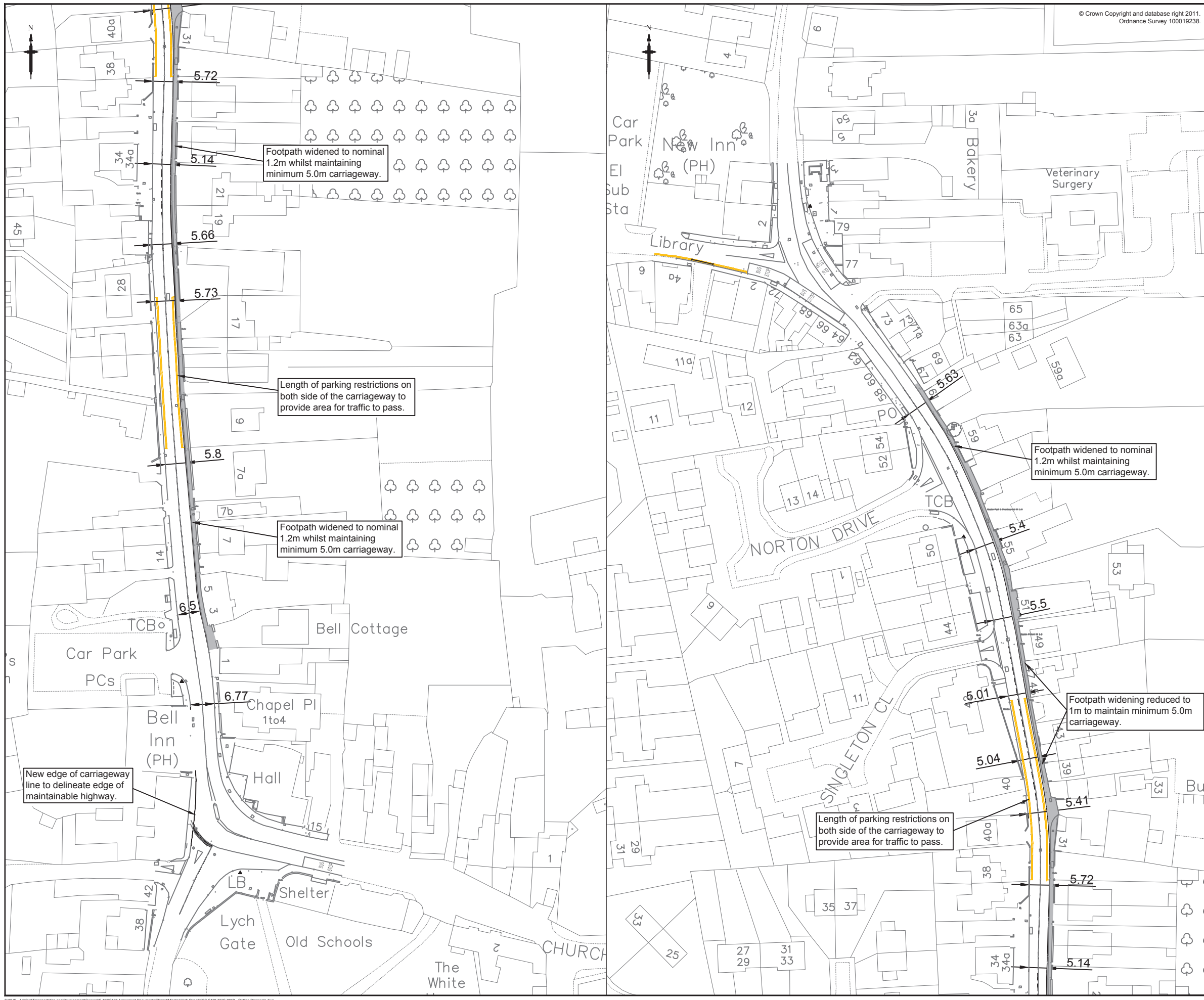

Rev	Revision Date	Purpose of revision	Drawn	Checked	Approved
B	27/11/14	EXTENT OF PARKING RESTRICTIONS EXTENDED	GDL	SB	SB
A	13/10/14	EXTENT OF PARKING RESTRICTIONS AMENDED	GDL	SB	SB
D	19/08/14	FIRST ISSUE	GDL	SB	SB



Kent County Council
Ashford Highway Depot
Henwood Industrial Estate
Ashford TN24 8AD
Tel: 03000 418181

Project
High Street Thanet

Drawing title
**Footpath and Congestion Improvements
Outline Design**

Drawing status
PRELIMINARY

Scale
1:500 at A1 Do not scale

Drawing number
KCC/S106/MHS/001 Rev
B

This drawing is not to be used in whole or part other than for the intended purpose and project as defined on this drawing. Refer to the contract for full terms and conditions.

This page is intentionally left blank

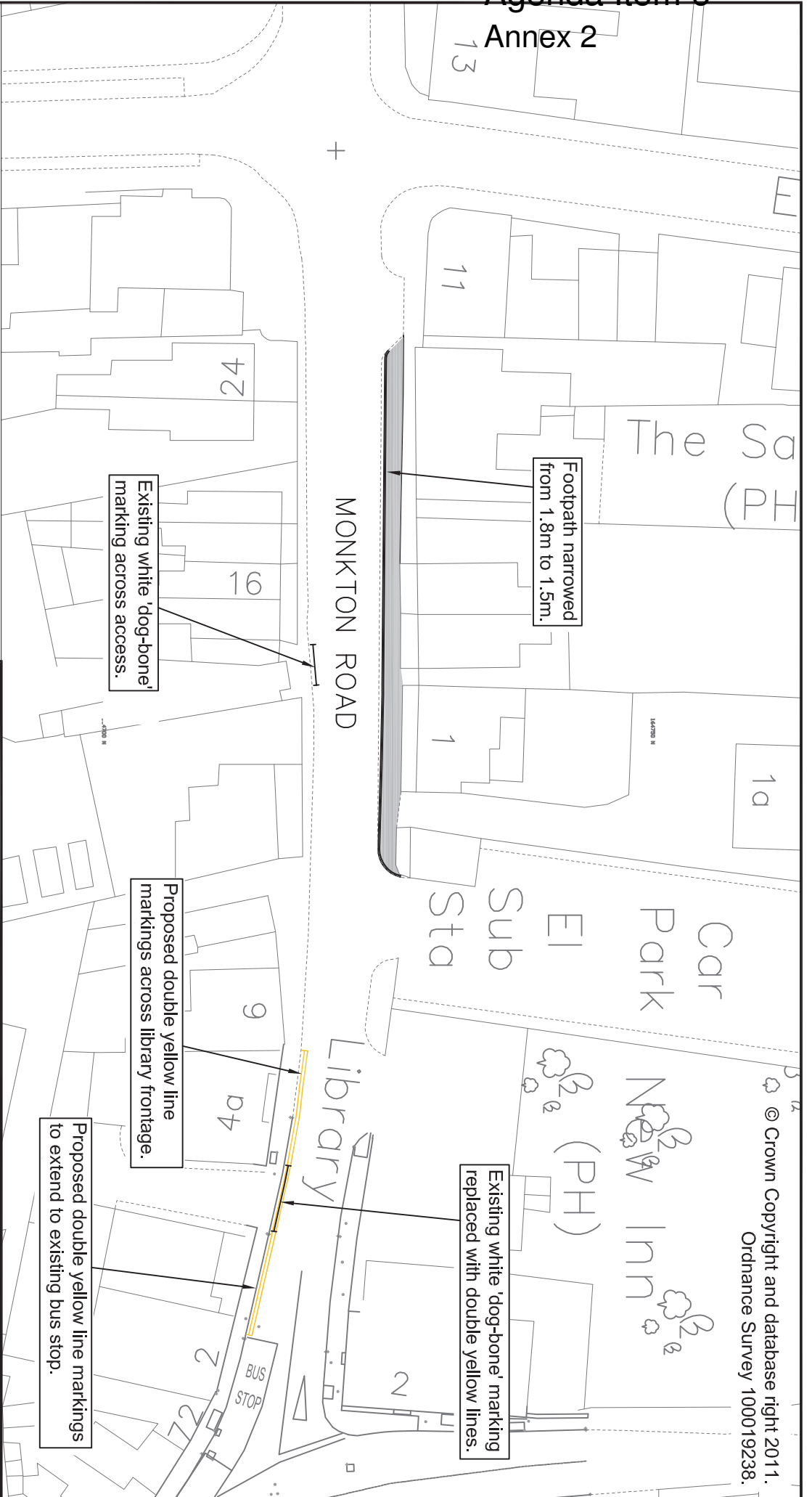

© Crown Copyright and database right 2011.
Ordnance Survey 100019238.

Rev	Revision Date	Purpose of revision	Drawn	Checked	Approved
A	13/10/14	FOOTPATH NARROWING EXTENDED DOUBLE YELLOW LINES ADDED	GDL	SB	SB
0	19/08/14	FIRST ISSUE	GDL	SB	SB

This drawing is not to be used in whole or part other than for the intended purpose and project as defined on this drawing. Refer to the contract for full terms and conditions.



Kent County Council
Ashford Highway Depot
Henwood Industrial Estate
Ashford TN24 8AD
Tel: 02000 418181

**High Street
Minster**

Drawing title
**Footpath And Congestion Improvements
Footpath Narrowing
Monkton Road**

Drawing status
PRELIMINARY

Scale
1:500 at A4

Drawing number
KCC/S106/MHS/002

Rev
A

This page is intentionally left blank

To: Thanet Joint Transportation Board
By: KCC Highways and Transportation
Date: 16th December 2014
Subject: Highway Works Programme 2014/15
Classification: Information Only

Summary: This report updates Members on the identified schemes approved for construction in 2014/15

1. Introduction

This report provides an update and summarises schemes that have been programmed for delivery in 2014/15

Footway and Carriageway Improvement Schemes – see Appendix A

Drainage Repairs & Improvements – see Appendix B

Street Lighting – see Appendix C

Developer Funded Works – see Appendix D

Transportation and Safety Schemes – see Appendix E

Public Rights of Way – see Appendix F

Member Highway Fund – see Appendix G

Major Projects – See Appendix H

Conclusion

1. This report is for Members information.

Contact Officers:

The following contact officers can be contacted on **03000 418181**

Kirstie Williams	Highway Manager (East)
Paul Valek	Thanet District Manager
Alan Casson	Resurfacing Manager
Katie Lewis	Drainage Manager
Sue Kinsella	Street Lighting Manager
Toby Butler	Intelligent Transport Systems Manager
Kelly Garrett	Transportation and Safety Schemes
Melvyn Twycross	PROW
Tony Ambrose	Structures Manager
Glenn Holliday	Developer Funded Works
Russell Boorman	Project Manager Major Projects

Appendix A – Footway and Carriageway Improvement Schemes

The delivery of these schemes is weather dependent; should it prove not possible to carry out these works on the planned dates, new dates will be arranged and the residents will be informed by a letter drop to their homes.

Surface Dressing – Contact Officer Wendy Boustead			
Road Name	Parish	Extent of Works	Current Status
Bedlam Court Lane	Minster	Whole Length	Completed
Foxborough Lane	Minster	Whole Length	Completed
Joss Gap Road	Broadstairs	Whole Length	Completed
Whitiness Road	Broadstairs	Whole Length	Completed
The Lanes	Minster	Whole Length	Completed
Grinsell Hill	Minster	Whole Length	Completed
Cottington Road	Minster	From its junction with Thorne Hill to A299 slip road	Works Postponed due to Gas works. To be reassessed for programme in Summer 2015.
Convent Road	Broadstairs and St Peters	From its junction with George Hill Road to its junction with Joss Gap Road	Completed
Hereson Road	Broadstairs and St Peters	From its junction with Sycamore Grange to its junction with Ramsgate Road	Completed
A255 Ramsgate Road	Broadstairs and St Peters	From its junction with Gladstone Road to Ramsgate Road roundabout	Completed
Micro Asphalt Schemes – Contact Officer Wendy Boustead			
Road Name	Parish	Extent of Works	Current Status
Radley Close	Broadstairs	Whole length including junction with Tina Gardens	Completed
Dumpton Lane	Ramsgate	From its junction with the railway bridge to its junction with College Road	Completed
Linden Avenue & Dalmaney Close	Broadstairs	Whole length	Completed
Pysons Road	Ramsgate and Broadstairs	From its junction with Margate Road to its junction with Hopes Lane	Completed
Vicarage Street	Broadstairs	Whole length	Completed
Church Street	Broadstairs	Whole length	Completed

High Street St Peters	Broadstairs	Whole length	Completed
Hopeville Avenue	Broadstairs	Whole length	Completed
Albion Road	Birchington	Whole length	Completed
Roxburgh Road	Westgate	Whole length	Completed
Sundew Grove	Ramsgate	Whole length	Completed
Hollicondane Road	Ramsgate	Whole length	Completed
Machine Resurfacing – Contact Officer Byron Lovell			
Road Name	Parish	Extent of Works	Current Status
A256 Westwood Road/Northwood Road Roundabout	Broadstairs	Eastbound and westbound approaches only	On hold due to SGN utility works
A28 Canterbury Road	St Nicholas-at-Wade	Southbound approach to roundabout	Completed
A255 High Street	Broadstairs	Both approaches to the pedestrian crossing near Carlton Avenue	Completed
Station Road/St Mildreds Road	Westgate	Westgate Bay Avenue to Railway bridge/St Mildreds Road to Roxburgh Road	Completed
School Lane	Ramsgate	Broad Street to Sussex Street	Completed
Northdown Park Road	Margate	Foreland Avenue junction to and including mini roundabout at Queen Elizabeth Avenue	Programmed to start Spring 2015
Northdown Road	Margate	Zion Place to Harold Road	Programmed to start Spring 2015
A299/A253 Monkton Rbt	Monkton	Roundabout Circulatory	Programmed to start Spring 2015
Footway Improvement - Contact Officer Neil Tree			
Road Name	Parish	Extent and Description of Works	Current Status
Callis Court Road	Broadstairs and St Peters	From its junction with Grange Road to its junction with Reading Street. This scheme is still in the design stages. Construction still to be determined.	On site works ongoing.

Appendix B – Drainage Repairs & Improvements

Drainage Repairs & Improvements - Contact Officer Katie Lewis			
Road Name	Parish	Description of Works	Current Status
Canterbury Road	Birchington	Dig out pond and installation of additional gullies	Completed
Sandwich Road	Cliffsend	Installation of apparatus to remedy flood issues at site during winter.	Completed
Nash Road	Margate	Installation of new gullies and soakaways	Completed
Dane Court Road	Broadstairs	Investigative works including pipework clearance. Reviewing report for possible further work	Completed
Staffordshire Street junction with Turner Street	Ramsgate	Installation of additional gullies and chamber.	Works due to start 1 st Dec 2014
Park Road	Ramsgate	Installation of new gullies and connecting pipework	To be programmed
Stone Barn Avenue	Birchington	Investigation works undertaken awaiting results of site survey.	Completed
Manston Court Road	Manston	Works to clean existing gullies, pipework and soakaways.	Works programmed to start 27 th January.
254 Canterbury Road	Birchington	New gully and pipework to be installed.	To be programmed.

Appendix C – Street Lighting

The following columns are being replaced as they have been identified as high risk during structural testing. Work is programmed to be completed by the end of November 2014.

Street Lighting Column Replacement – <i>Contact Officer Sue Kinsella</i>			
Road Name	Location	Column Ref	Status
MINNIS ROAD	BIRCHINGTON	HMCM004	COMPLETE
MINNIS ROAD	BIRCHINGTON	HMCM005	COMPLETE
MINNIS ROAD	BIRCHINGTON	HMCM019	COMPLETE
MINNIS ROAD	BIRCHINGTON	HMCM020	COMPLETE
MINNIS ROAD	BIRCHINGTON	HMCM029	COMPLETE
MINNIS ROAD	BIRCHINGTON	HMCM031	COMPLETE
MINNIS ROAD	BIRCHINGTON	HMCM035	COMPLETE
MINNIS ROAD	BIRCHINGTON	HMCM036	COMPLETE
SEA ROAD	WESTGATE	HSAU047	COMPLETE
SEA ROAD	WESTGATE	HSAU051	COMPLETE
SEA ROAD	WESTGATE	HSAU052	COMPLETE
SEA ROAD	WESTGATE	HSAU053	COMPLETE
SEA ROAD	WESTGATE	HSAU054	COMPLETE
SEA ROAD	WESTGATE	HSAU055	COMPLETE
SEA ROAD	WESTGATE	HSAU057	COMPLETE
SEA ROAD	WESTGATE	HSAU058	COMPLETE
SEA ROAD	WESTGATE	HSAU063	COMPLETE
SEA ROAD	WESTGATE	HSAU064	COMPLETE
SHOTTENDANE RD	MARGATE	HSCA006	INCOMPLETE
SHOTTENDANE RD	MARGATE	HSCA012	INCOMPLETE
SHOTTENDANE RD	MARGATE	HSCA014	INCOMPLETE
SHOTTENDANE RD	MARGATE	HSCA019	INCOMPLETE
SHOTTENDANE RD	MARGATE	HSCA024	INCOMPLETE
SHOTTENDANE RD	MARGATE	HSCA026	INCOMPLETE
SHOTTENDANE RD	MARGATE	HSCA027	INCOMPLETE
SHOTTENDANE RD	MARGATE	HSCA028	INCOMPLETE
SHOTTENDANE RD	MARGATE	HSCA030	INCOMPLETE
SHOTTENDANE RD	MARGATE	HSCA031	INCOMPLETE
GRANGE ROAD	RAMSGATE	HGBB013	COMPLETE
GRANGE ROAD	RAMSGATE	HGBB023	COMPLETE
GRANGE ROAD	RAMSGATE	HGBB025	COMPLETE
LEOPOLD STREET	RAMSGATE	HLAZ001	COMPLETE
LEOPOLD STREET	RAMSGATE	HLAZ002	COMPLETE
LEOPOLD STREET	RAMSGATE	HLAZ003	COMPLETE
LEOPOLD STREET	RAMSGATE	HLAZ004	COMPLETE
CANTERBURY ROAD EAST	RAMSGATE	HCAT037	TO BE PROGRAMED
EASTERN EPLANADE	MARGATE	HEAF001	COMPLETE
EASTERN EPLANADE	MARGATE	HEAF003	COMPLETE
NORTHDOWN ROAD	MARGATE	HNCO033	COMPLETE

NORTHDOWN ROAD	MARGATE	HNCO036	COMPLETE
NORTHDOWN ROAD	MARGATE	HNCO037	COMPLETE
NORTHDOWN ROAD	MARGATE	HNCO051	COMPLETE
NORTHDOWN ROAD	MARGATE	HNCO066	COMPLETE
NORTHDOWN ROAD	MARGATE	HNCO076	COMPLETE
NORTHUMBERLAND AVENUE	MARGATE	HNBV002	COMPLETE
NORTHUMBERLAND AVENUE	MARGATE	HNBV003	COMPLETE
NORTHUMBERLAND AVENUE	MARGATE	HNBV005	COMPLETE
NORTHUMBERLAND AVENUE	MARGATE	HNBV007	COMPLETE
NORTHUMBERLAND AVENUE	MARGATE	HNBV011	COMPLETE
PALM BAY AVENUE	MARGATE	HPAC029	COMPLETE
PALM BAY AVENUE	MARGATE	HPAC031	COMPLETE
PALM BAY AVENUE	MARGATE	HPAC032	COMPLETE
ETHELBERT CRESCENT	MARGATE	HEBU005	COMPLETE
WYNDHAM AVENUE	MARGATE	HWDZ001	COMPLETE
BOUNDRY ROAD	RAMSGATE	HBCF017	COMPLETE
VICTORIA ROAD	RAMSGATE	HVAQ009	COMPLETE
ALL SAINTS AVENUE	MARGATE	HABN009	COMPLETE
ALL SAINTS AVENUE	MARGATE	HABN012	COMPLETE
HIGH STREET	MARGATE	HHES034	TO BE PROGRAMED
NETHERCOURT HILL	RAMSGATE	HNAO015	TO BE PROGRAMED
HAIN ROAD	RAMSGATE	HHAB049	TO BE PROGRAMED
HAIN ROAD	RAMSGATE	HHAB050	TO BE PROGRAMED
HAIN ROAD	RAMSGATE	HHAB057	TO BE PROGRAMED
CHANNEL ROAD	WESTWOOD IND EST	HWCI003	PROGRAMED
CHANNEL ROAD	WESTWOOD IND EST	HWCI005	PROGRAMED
CONTINENTAL APPROACH	WESTWOOD IND EST	HCJC001	PROGRAMED
CONTINENTAL APPROACH	WESTWOOD IND EST	HCJC004	COMPLETE
STRASBOURG STREET	WESTWOOD IND EST	HSIQ001	COMPLETE
TIVOLI ROAD	MARGATE	HTCD003	TO BE PROGRAMED
TIVOLI ROAD	MARGATE	HTCD004	TO BE PROGRAMED
TIVOLI ROAD	MARGATE	HTCD006	TO BE PROGRAMED
TIVOLI ROAD	MARGATE	HTCD010	TO BE PROGRAMED
MARGATE ROAD	RAMSGATE	HMAU121	TO BE PROGRAMED
WESTWOOD ROAD	BROADSTAIRS	HWCK013	TO BE PROGRAMED
MONKTON ROAD	MINSTER	HMCU002	UNDER WAY
MONKTON STREET	MONKTON	TO HTDH103	UNDER WAY
SANDWICH ROAD	RAMSGATE	HSAL066	IMPROVEMENT SCHEME UNDER WAY
HAWLEY STREET	MARGATE	HHGB001	STILL AWAITING PROGRAMING
HIGH STREET	BROADSTAIRS	HHBX001	COMPLETE
HIGH STREET	BROADSTAIRS	HHBX002	COLUMN UP BUT WILL REQ PRIVATE SERVICE.

			ORDER RAISED
HIGH STREET	BROADSTAIRS	HHBX003	COMPLETE
JOHN STREET	BROADSTAIRS		COMPLETED WITH A WALL MOUNTED UNIT
HIGH STREET	RAMSGATE	NEW LIGHTING SCHEME	Complete except for column 1 Problems with UKPN service, upon excavation it was found that there was not enough clean main to joint onto. I have found an alternative point of supply but the connection will need to be via a private supply.

Appendix D – Developer Funded Works

Developer Funded Works (Section 278 Works) Contact Officer Glenn Holliday			
Road Name	Parish	Description of Works	Current Status
Westwood TH2016	Ramsgate	New Neighbouring Road network.	On Maintenance
Ramsgate Road TH2049	Broadstairs	Hereson School. New Access and zebra crossing on Ramsgate Road and New access of Merrivale Heights serving residential development.	Works Completed.
The Centre, Newington TH2037	Ramsgate	Highway Works associated with regeneration scheme.	S278 agreement signed and works ongoing
Northdown Road Th00036	Margate	Capital House Section 38 residential development with new access onto Northdown Road.	On Maintenance
Marstons Pub Margate Road TH3008	Broadstairs	New access serving public house.	Works Complete
Sainsbury's Westwood Cross TH3013/3014/ 3006	Broadstairs	New link road between New Haine Road and Margate Road, including amendments to existing roundabouts, serving new superstore	S278 Agreement for New Haine Road Signed and works are ongoing. No signed Agreement for Margate road works, work commence December 2014 (no works due Christmas embargo for Westwood Cross) Agreement signed and works substantially completed and store open. Other scheme works due completion due 2015.
Honeysuckle Road TH2048	Ramsgate	New scheme footway works and new access to residential development.	On maintenance.
Boundary Road TH3007	Ramsgate	New access to Aldi Store	Works Ongoing
Newington Road Th3016	Ramsgate	New access to private development	Design approved, awaiting signing of agreement before works can commence
Melbourne Ave Th3015	Ramsgate	New access to private development	Works completed.

Appendix E – Transportation and safety schemes

The Traffic Schemes Team is implementing a number of schemes within the Thanet District, in order to meet Kent County Council's strategic targets (for example, addressing traffic congestion, or improving road safety). New Casualty Reduction Measures (CRMs) have been identified to address a known history of personal injury crashes; for Members' information, these are specifically highlighted with an asterisk:

Local Transport Plan Funded Schemes- Contact Officer Kelly Garrett			
Road Name	Parish	Description of Works	Current Status
Fort Road/ Love Lane/ King Street/ Hawley Street	Margate	Pedestrian route improvements to Turner Contemporary. Zebra crossing to be installed across Hawley Street. Footway to be widened on King Street. Localised kerb works/ build outs. Extension to the old town 20mph zone.	Work complete.
Broadley Road/ St Peters Road	Margate	Have secured funding to install a toucan crossing at the junction of Broadley Road and St Peters Road.	Works complete.
Park Lane/ Brunswick Road*	Birchington	One mains powered interactive sign to be installed with additional slow markings. Existing 'side road ahead' sign to be moved to accommodate this. Speed limit terminal signs to be moved and TRO revised.	Works complete.
Canterbury Road West and Sandwich Road	Cliffsend	Phase 2: Making Phase 1 elements permanent & implementation of remaining traffic calming measures on Canterbury Road West & Sandwich Road.	Works on site at Sandwich Road and complete on Canterbury Road West.
Thanet QBP - public transport infrastructure	Margate	Bus stop infrastructure improvements at pair of bus stops on Cecil Street, Margate (opposite & adjacent to Thanet DC offices). To include footway widening at stop opposite Thanet DC offices.	Works due to be completed by early December 2014.
A255 Broadstairs Road *	Broadstairs	Pedestrian Crossing outside Charles Dickens Secondary School.	Works programmed for February 2015.

A28 Canterbury Road *	St Nicholas-at-Wade/ Birchington	Phase 1: On section between St Nicholas roundabout and Brooksend: Signing/ lining/ road studs/ reduced speed limit on dual carriageway/ mobile safety camera at Brooksend.	Works programmed for w/c 8 December 2014.
-----------------------	-------------------------------------	--	---

Appendix F – Public Rights Of Way

Public Rights of Way – Contact Officer Melvyn Twycross			
Path No	Parish	Description of Works	Current Status
TR18	Ramsgate	Surface improvements to bridleway	Works due to commence shortly
TE458	Minster	Surface improvements to footpath	Works out to tender – will proceed subject to funding

Appendix G – Member Highway Fund

All Members in the Thanet District have now submitted applications, but many are still at the design or approval stage. The following schemes are those which have been approved by both the relevant Member and have been approved by John Burr, and is up to date as of 27th November 2014.

More detail on the schemes below can be found within the individual Member update sheets which are available for each Member to access online.

Alan Terry and Zita Wiltshire (combined) – Broadstairs and Sir Moses Montefiore

Scheme	Cost	Status
Callis Court Road, Broadstairs – Resurfacing of public footway from Grange Road junction to Reading Street junction and installation of new SLOW markings and road narrowing signs.	£9,600 contribution	Currently on site
Broadstairs Road roundabout – Summer and winter planting of roundabout and general maintenance of site for one full year.	£5,420	Winter planting complete.

Alan Terry – Broadstairs and Sir Moses Montefiore

Scheme	Cost	Status
Westwood Road, Broadstairs – installation of new bus shelter at the St. Peters bound bus stop opposite Asda. Bus shelter will include internal light and advertising boards.	£10,240	Complete

Zita Wiltshire – Broadstairs and Sir Moses Montefiore

Scheme	Cost	Status
Victoria Parade, Broadstairs – installation of pedestrianized zone with new block paving surface.	£12,710	Programmed for 1 st December 2014
High Street, St Peter's – installation of double yellow lines outside Ashton Court vehicular access.	£860	Advertising sealed traffic order

Jeffrey Elenor – Margate West

No outstanding schemes

Martyn Heale and Trevor Shonk – Ramsgate

Scheme	Cost	Status
Wellington crescent, Ramsgate – Installation of new pedestrian refuge island	£11,600	Complete
St Luke's Avenue, Ramsgate – New traffic calming scheme involving 5 series of traffic cushions.	£12,620	Complete
Margate Road, Ramsgate – Installation of a zebra crossing near the junction with Coxes Lane.	£22,020	Complete

Mo Elenor – Margate and Cliftonville

Scheme	Cost	Status
A28 Marine Terrace, Margate – Scheme to tidy the roundabout near the station, and plant various bedding plants and shrubs.	£1,875	Awaiting programme date
Northumberland Avenue, Cliftonville (o/s Primary School) – Installation of new zebra crossing and kerb build out. Scheme to be jointly funded with KCC Member William Scobie.	£10,580	Complete
Trinity Square / Trinity Hill, Margate – Installation of 2 new bollards to stop drivers over running the footway.	£715	Complete

Roger Latchford – Birchington and Villages

Scheme	Cost	Status
Molineux Road, Minster – 3 new trees to replace those that were recently removed due to disease and weather damage.	£1,182	Programmed for January 2015.

William Scobie – Margate and Cliftonville

Scheme	Cost	Status
Northumberland Avenue, Cliftonville (o/s Primary School) – Installation of new zebra crossing and kerb build out. Scheme to be jointly funded with KCC Member Mo Elenor.	£10,580	Complete
Ramsgate Road (o/s QEQM hospital) – Installation of new yellow box markings.	£3,325	Complete
Northdown Road, Margate – Request for zebra crossing outside Aldi supermarket	£18,832	Consultation to commence 6 th December 2014.

1.1 Legal Implications

1.1.1 Not applicable.

1.2 Financial and Value for Money Considerations

1.2.1 Not applicable.

1.3 Risk Assessment

1.3.1 Not applicable.

Contact: Paul Valek 03000 418181

This page is intentionally left blank

To: Thanet District Council Joint Transportation Board

By: **Andrew Loosemore** – Head of Highway Operations

Date: 18th September 2014

Subject: Local Winter Service Plan

Classification: Information only

Summary: This report outlines the arrangements that have been made between Kent County Council and Thanet District Council to provide a local winter service in the event of an operational snow alert in the district.

Introduction

1. Kent County Council Highways, Transportation & Waste (KCC HTW) takes its winter service responsibilities very seriously and is proactive as well as reactive to winter weather conditions. Winter service costs KCC in the region of £3.2m every winter and needs careful management to achieve safety for the travelling public and to be efficient. The Highways Operations teams in HTWW work to ensure that the winter service standards and decisions made are consistent across the whole county.

HTW prepares an annual Winter Service policy and plan which are used to determine actions that will be taken to manage its winter service operations. The policy will be discussed at the Environment, Highways and Waste Cabinet Committee on 17 September 2014.

District based winter service plans

2. The Local Winter Service Plan for the Thanet District is a working document. It will evolve and be revised as necessary throughout the year. The document will be available on the KCC website. This document complements the KCC Winter Service Policy and Plan 2014-15. Following successful work in previous years with district councils, arrangements have again been put in place this year whereby labour from district councils can be used during snow days. Additionally HTW will supply a quantity of a salt/sand mixture to district councils to use on the highway network. The details are contained in the plan which enhances the work that HTW will continue to do in providing a countywide winter service. The local plan comes into effect when a snow operational alert is declared that affects the district of Thanet.

http://www.kent.gov.uk/roads_and_transport/highway_maintenance/winter_maintenance_and_repairs/thanet_winter_s.aspx

Pavement clearance

3. Areas for clearing pavements have been identified in the local plan. These are the areas where local knowledge has indicated that people are concerned and would most like to be kept clear when there is snow and ice.

Farmers

4. The work that our contracted farmers have done in recent years is greatly appreciated and has made a big difference in keeping rural areas clear on snow days. Again this year farmers will have predetermined local routes and will use their own tractor and KCC ploughs for clearing snow. The ploughs supplied are serviced by KCC each year. Each farmer will have plans detailing the roads that they are responsible for ploughing. When snow reaches a depth of 50mm on roads in their areas the farmers will commence ploughing notifying KCC as agreed in their contract. A list of farmers and their contact details can be found in the local plan, (although some personal information will not be available via this report or the website due to Data Protection legislation).

Conclusion

5. Working in partnership with the district councils will enable HTW to provide an effective winter service across the county.

Recommendations

6. Members are asked to note this report.

Background documents: Kent County Council Winter Service Policy and Plan 2014/15

Contact officer:

Paul Valek -Tel: 03000 418181

TRAFFIC MANAGEMENT - PARKING & WAITING RESTRICTIONS – THANET

To: **Thanet Joint Transportation Board – 16 December 2014**

By: **Civil Enforcement Manager**

Classification: **Unrestricted.**

Ward: **Across the District – Various**

Summary: **The report presents the results of investigations at various locations where parking restrictions have been requested over the last four months.**

For Recommendation: **Members are requested to recommend that the parking and waiting restrictions are advertised for public comment/objection.**

1. Introduction and Background

- 1.1 Since 2005 the responsibility for parking matters in the Thanet District is split between Kent Highways and Transportation for requests relating to safety and Thanet District for amenity requests. Requests that both councils have received over the past four months have been investigated and those that are considered to be viable are shown with recommendations in appendix 1.
- 1.2 Making changes to Traffic Regulation Orders is a lengthy and costly process involving changes to legal documents and thorough public consultation. In order to optimise the handling of these changes, the requests are consolidated into an annual review. Objections that are received on traffic related matters during the public consultation will be brought back to the Board later in the year for a decision about whether to implement the proposed changes.
- 1.3 The officers' recommendations as to whether each proposal should be implemented are based on the General Provision for Traffic Regulation in the Road Traffic Regulation Act 1984. Within the Act changes are considered to be justified:
- a) where a road safety hazard exists;
 - b) where traffic flow on main roads is impeded;
 - c) where access is seriously obstructed, particularly for emergency vehicles;
 - d) where damage to the highway or to buildings is caused by particular classes of vehicle;
 - e) where serious loss of amenity is caused.
- 1.4 Additionally, as a general rule, parking restrictions are not recommended in remote locations where there is little chance of enforcement. The opportunity has also been taken to review locations where parking restrictions can be removed.

2. Options available

2.1 Members of the Board can:

2.11 Support the officers' recommendations about whether to consult on each of the proposals,

2.12 Make a different recommendation about whether to consult on individual proposals,

2.13 Recommend amendments to any of the proposals to be advertised.

3. Corporate Implications

3.1 Financial

3.1.1 Parking and waiting restrictions are funded, managed and enforced by the Thanet District Council using the decriminalisation budget.

3.1.2 No additional staffing resources are proposed, as the majority of the controls should be self-enforcing.

4.2 Legal

4.2.1 There are no legal implications.

5.3 Corporate

5.3.1 The proposals are intended to improve access, sight lines and the free flow of traffic. This is applicable not only to residential traffic but also to Emergency Service vehicles and stagecoach. If controls are not introduced, having identified a problem and proposed a solution and if an incident were to occur, it is possible that Members could be challenged for a failure to discharge their duty of care.

6.4 Equity and Equalities

6.4.1 Some proposals will improve sight lines not only for drivers but also for pedestrians. Additionally, some waiting restrictions on corners will discourage inconsiderate parking and improve pedestrian access to footways. This will be of benefit to both able bodied and disabled road users.

7.0 Recommendation

7.1 That subject to the views of this Board, the recommendations shown in appendix 1 are approved, and

7.2 That the proposals which require statutory consultation are advertised, and that any traffic related objections are reported back to a future meeting of the Board.

Contact Officer:	<i>Robin Chantrill-Smith (Civil Enforcement Manager) 01843 577472</i>
Reporting to:	<i>Gavin Waite (Head of Operational Services) 01843 577840</i>

Background Papers None

Annex List	
<i>Annex 1</i>	<i>List of sites and site plans to be advertised.</i>

PARKING & WAITING REVIEW DECEMBER 2014

APPENDIX 1 RECOMMENDATIONS

REF	LOCATION	COMPLAINT	SITE VISIT	COMMENTS	PLAN
1	Salisbury Avenue, j/w Dumpton Park Drive, Broadstairs.	Residents, Members, TDC and KCC – are concerned about inconsiderate parking.	17/09/14 RCS, KG & LD	Agree. To install Double Yellow line corner protection to deal with sight lines, reduce potential vehicular conflict.	See site plan 1
2	Ethelbert Road, Margate.	Residents & members – are concerned about the lack of parking.	17/09/14 RCS, KG & LD	Agree. To remove some sections of yellow lines to help with lack of parking.	See site plan 2
3	Ethelbert Road, Margate.	Residents & members – are concerned about the lack of parking.	17/09/14 RCS, KG & LD	Agree. To remove some sections of yellow lines to help with lack of parking.	See site plan 3
4	Fort Crescent, Margate.	Business – concerned about getting delivers.	17/09/14 RCS, KG & LD	Agree. To install a loading bay which would be in operation between 8 am and 12 noon Mon-Saturday.	See site plan 4
5	Garrard Avenue, Margate.	Residents, TDC and KCC – are concerned about inconsiderate parking.	17/09/14 RCS, KG & LD	Agree. To install Double Yellow lines on one side of the bend in the road to deal with sight lines and reduce potential vehicular conflict.	See site plan 5
6	Old Crossing Road, j/w Meadow Road, Margate.	Members & TDC– are concerned about inconsiderate parking.	17/09/14 RCS, KG & LD	Agree. To install Double Yellow line corner protection to deal with sight lines, reduce potential vehicular conflict.	See site plan 6
7	Queens Arms Yard, Margate	Residents, TDC & KCC are concerned about inconsiderate parking.	12/11/14 RCS, KG & PV	Agree. To install Double Yellow lines for the entire length to deal with sight lines, reduce potential vehicular conflict and inconsiderate parking.	See site plan 7
8	Albion Mews, j/w Cottage Road, Ramsgate.	Residents, TDC and KCC – are concerned about inconsiderate parking.	17/09/14 RCS, KG & LD	Agree. To install Double Yellow lines on one side of the junction to deal with sight lines, reduce potential vehicular conflict.	See site plan 8
9	Clifton Road, Ramsgate.	TDC & KCC are concerned about inconsiderate parking.	17/09/14 RCS, KG & LD	Agree. To extend the Double Yellow Lines to assist vehicles getting round the bend in the road.	See site plan 9
10	Townley Street, Ramsgate.	Residents – are concerned about inconsiderate parking.	17/09/14 RCS, KG, LD	Agree. To install additional Double yellow lines along one side and in sections of the road to deal with sight line issues, reduce potential vehicular conflict.	See site plan 10

This page is intentionally left blank

Salisbury Avenue/Dumpton Park Drive, Broadstairs. (Site Plan 1)

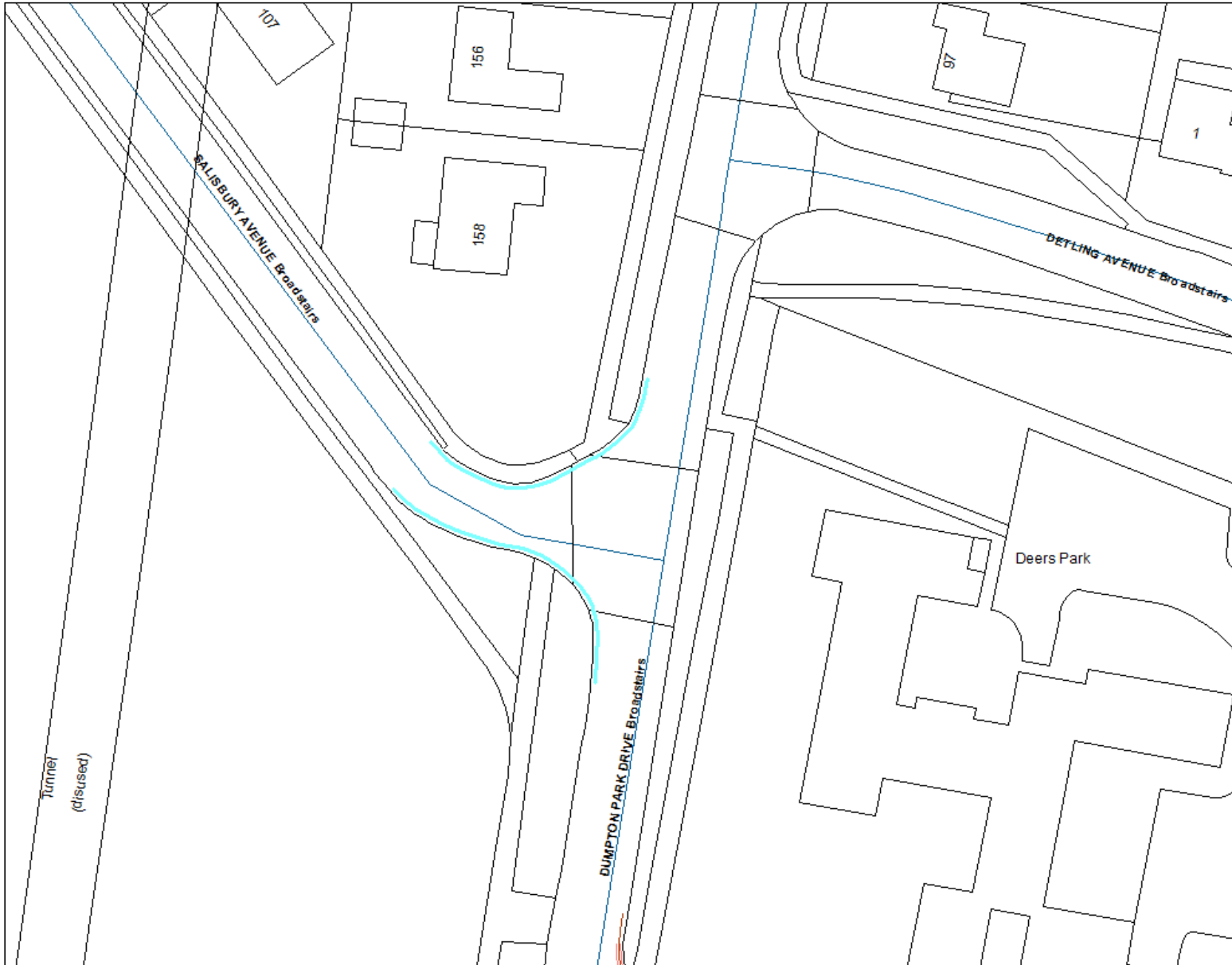

Proposed 15 metres double yellow line corner protection on the junction with Dumpton Park Drive



Site Plan 1
Salisbury Avenue
/ Dumpton Park
Drive,
Broadstairs

SLI 100018261

This page is intentionally left blank

Ethelbert Road, Margate. (Site Plan 2)

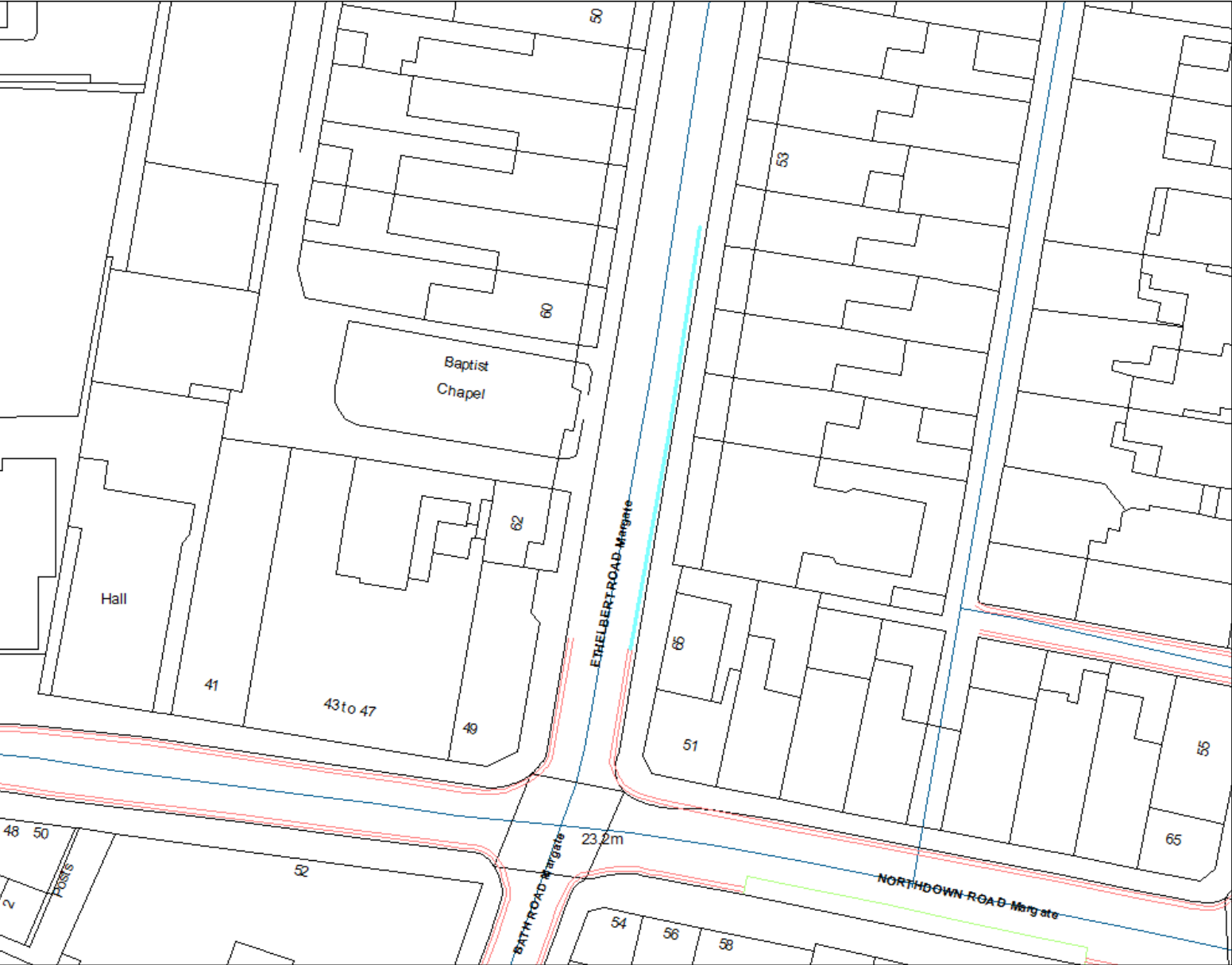

Proposed reduction of existing double yellow line



Site Plan 2
Ethelbert Road
Margate

SLI 100018261

Annex 3
Agenda Item 9

This page is intentionally left blank

Ethelbert Road, Margate. (Site Plan3)

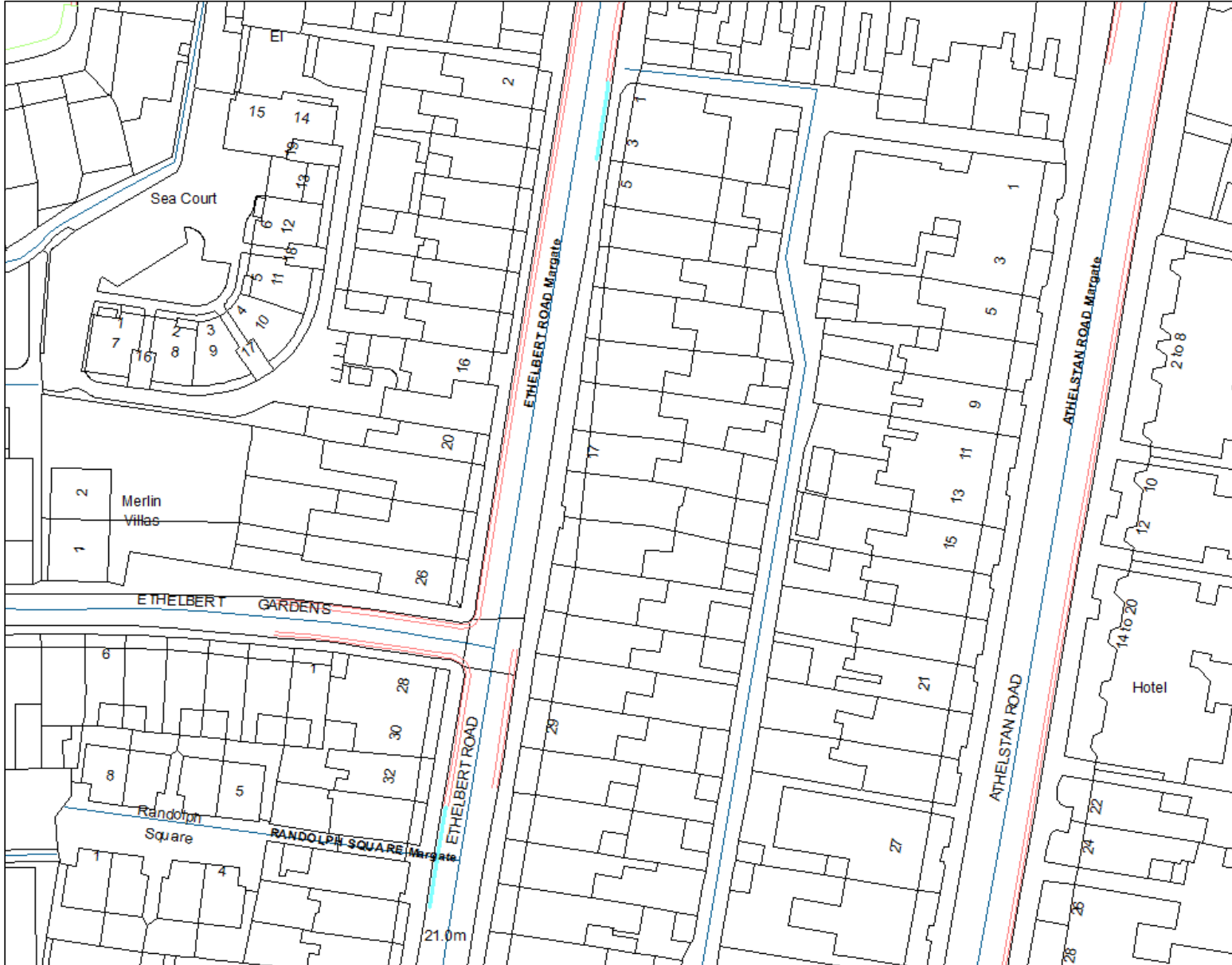

Proposed reduction of existing double yellow line



Site Plan 3
Ethelbert Road,
Margate

SLI 100018261

This page is intentionally left blank

Fort Crescent, Margate. (Site Plan 4)

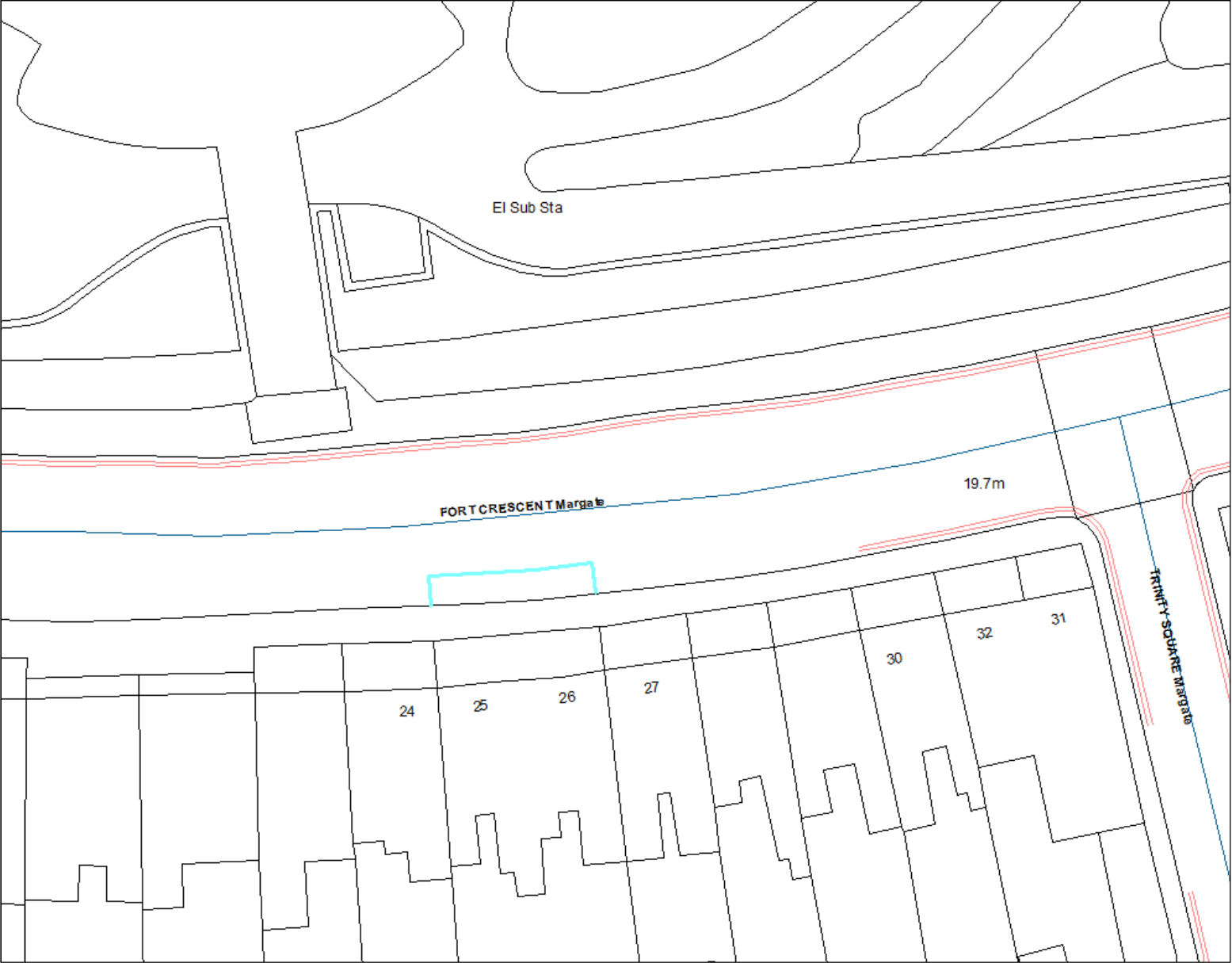

Proposed loading bay between the hours of 8am to 12 noon Monday – Saturday.



Site Plan 4
Fort Crescent,
Margate

SLI 100018261

Annex 5
Agenda Item 9

This page is intentionally left blank

Garrard Avenue, Margate. (Site Plan 5)



Proposed double yellow line corner protection on one side.



Site Plan 5
Garrard Avenue,
Margate

SLI 100018261

Annex 6
Agenda Item 9

This page is intentionally left blank

Old Crossing Road/Meadow Road, Margate. (Site Plan 6)

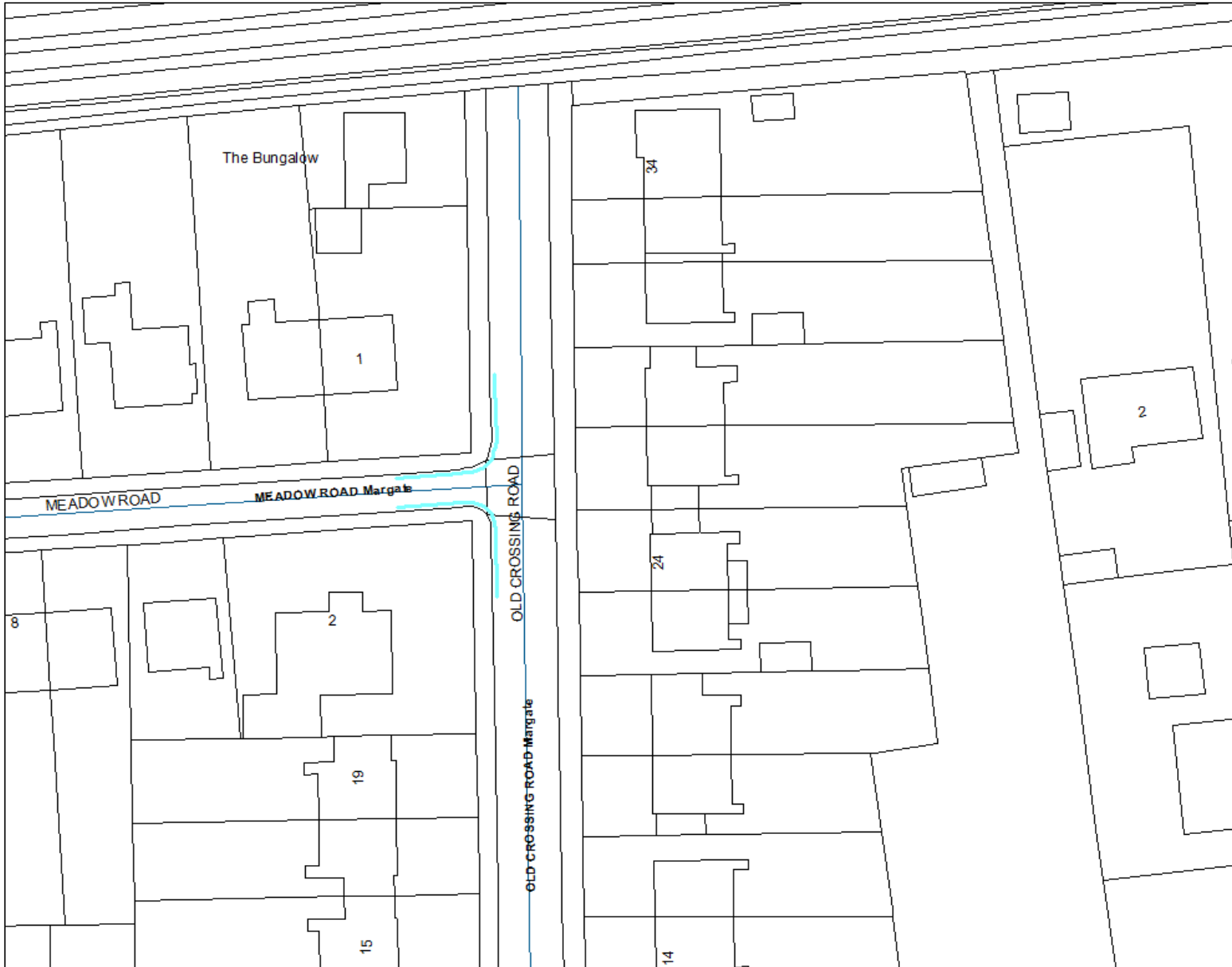

Proposed 10 metre double yellow line corner protection on the junction with Meadow Road



Site Plan 6
Old Crossing Road
/ Meadow Road,
Margate

SLI 100018261

Annex 7
Agenda Item 9

This page is intentionally left blank

Queens Arms Yard, Margate. (Site Plan 7)

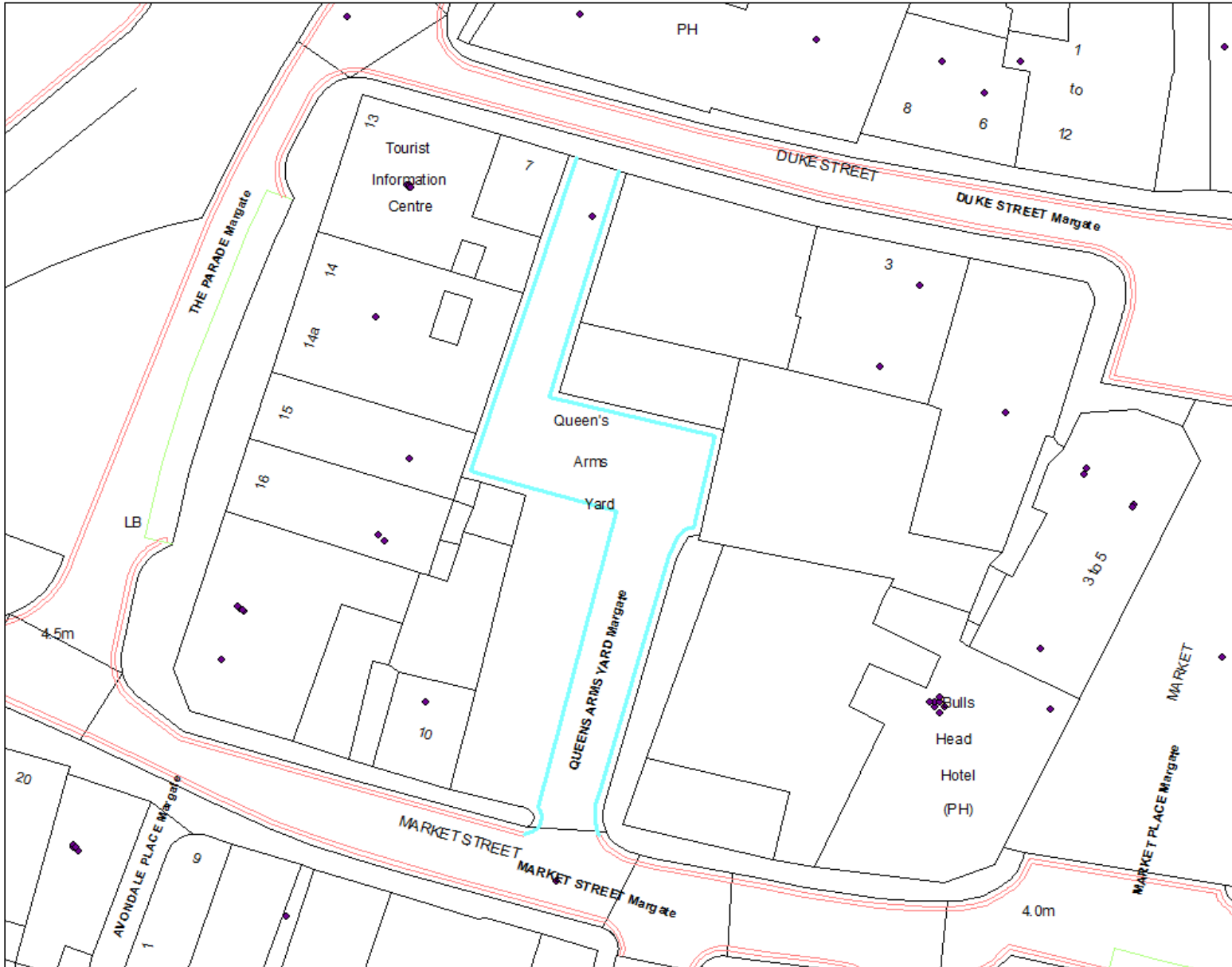

Proposed double yellow lines both side of highway



Site Plan 7
Queen Arms
Yard, Margate

SLI 100018261

This page is intentionally left blank

Albion Mews/Cottage Road, Ramsgate. (Site Plan 8)

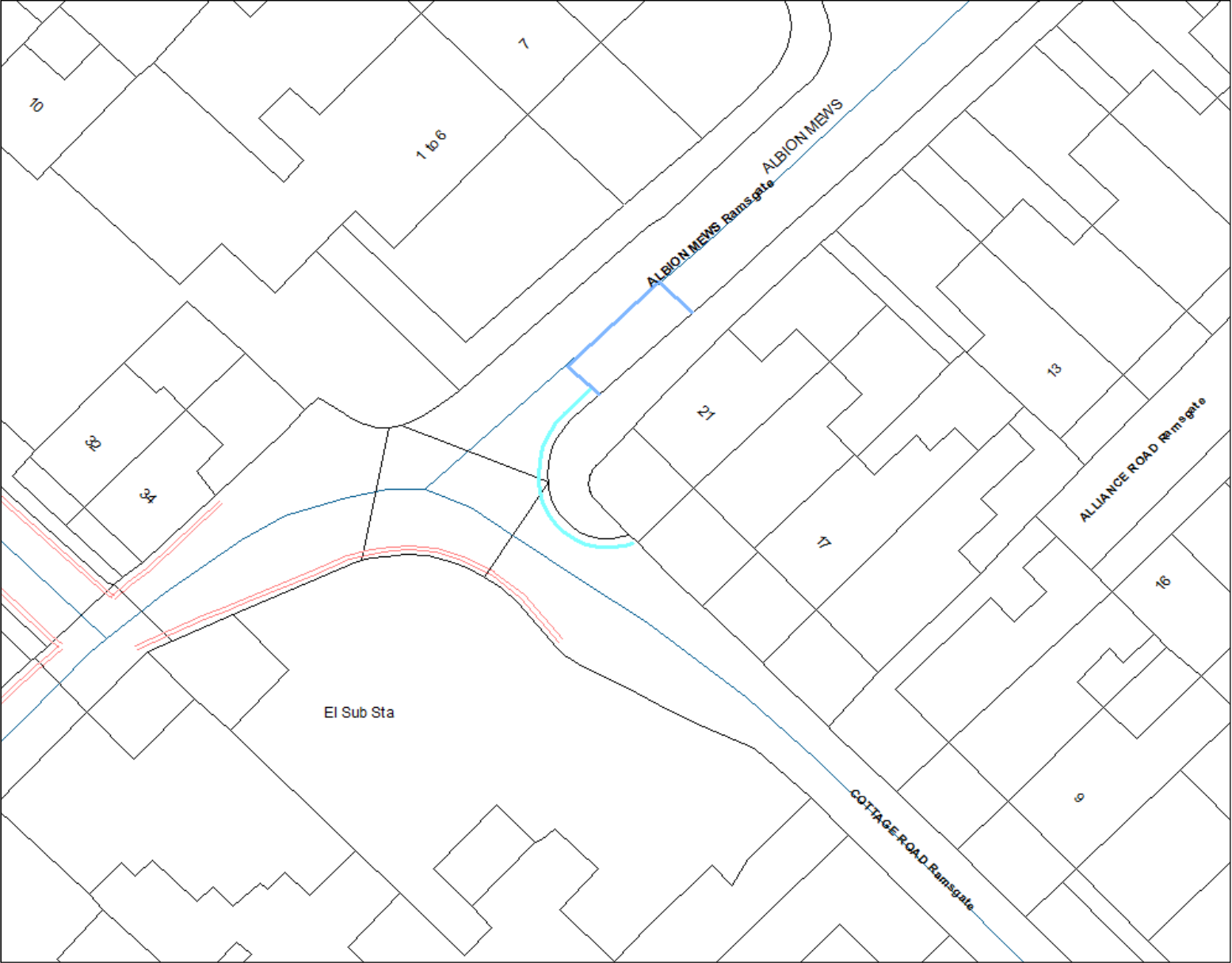

Proposed corner protection on one side of the junction for Albion Mews and Cottage Road



Site Plan 8
Albion Mews /
Cottage Road,
Ramsgate

SLI 100018261

Annex 9
Agenda Item 9

This page is intentionally left blank

Clifton Road, Ramsgate. (Site Plan 9)

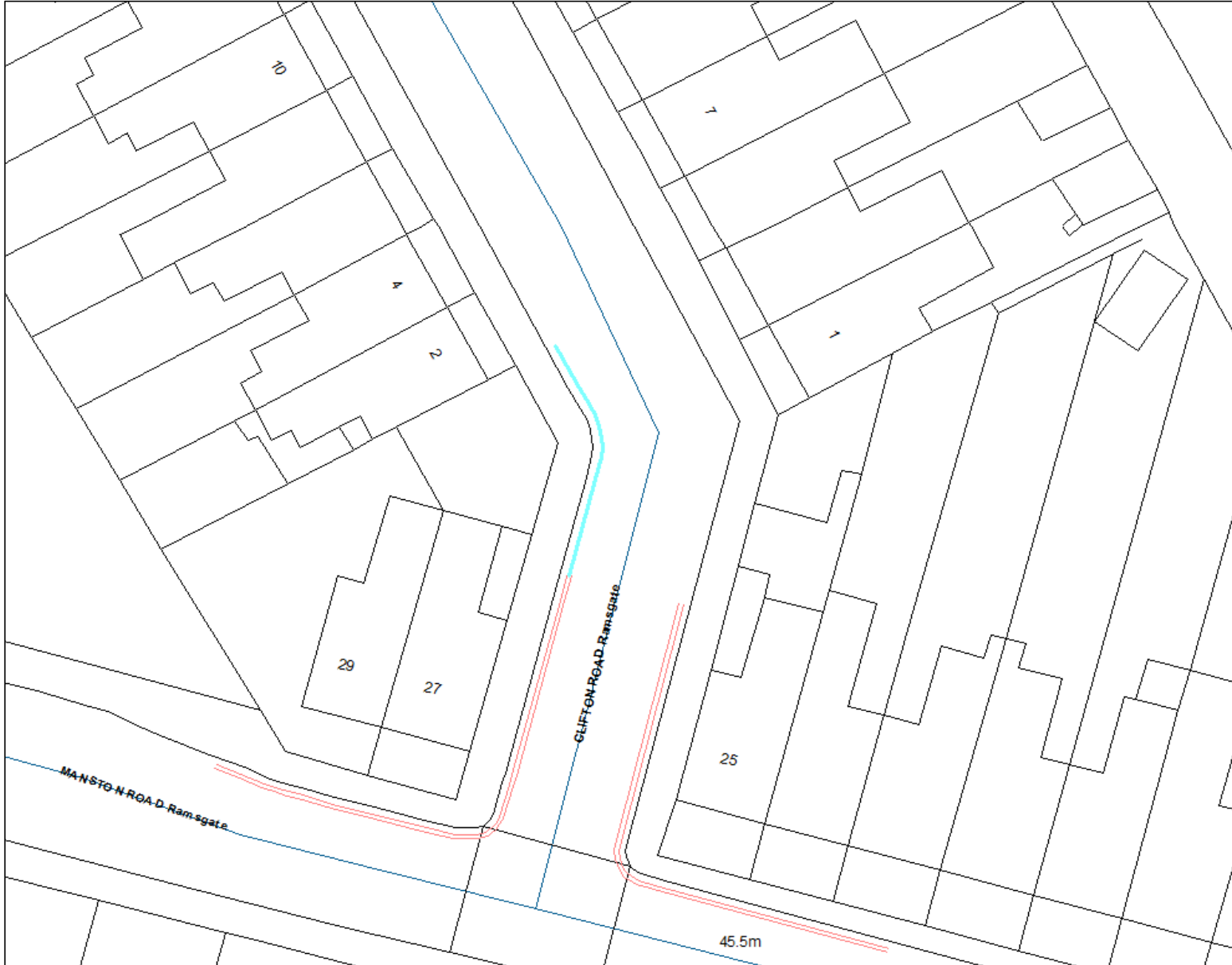

Proposed extension of double yellow line for corner protection



Site Plan 9
Clifton Road,
Ramsgate

SLI 100018261

Agenda Item 9
Annex 10

This page is intentionally left blank

This page is intentionally left blank

PARKING & WAITING RESTRICTIONS – UPDATE SUMMARY

To: **Thanet Joint Transportation Board – 16 December 2014**

By: **Civil Enforcement Manager**

Classification: **Information only.**

Ward: **Across the District - Various**

Summary: **This report provides an update and summarises schemes that have been through the Joint Transportation Board.**

For information only

1.0 Introduction and Background

1. This report provides an update and summarises parking and waiting restrictions and any schemes that have been through the Joint Transportation Board and what stage in the process they have reached since the last meeting.

Parking and Waiting Restrictions – see Appendix A

2.0 Conclusion

2. This report is for Members information.

Contact Officer:	<i>Robin Chantrell-Smith (Civil Enforcement Manager) 01843 577472</i>
Reporting to:	<i>Gavin Waite (Head of Operational Services) 01843 577840</i>

Annex List	
<i>Annex 1</i>	<i>List of sites and their current status.</i>

This page is intentionally left blank

PARKING & WAITING RESTRICTIONS UPDATE DECEMBER 2014

Appendix 1

LOCATION	Description of Scheme	Date at JTB	Current Status
<u>Kings Avenue & Queens Avenue</u> j/w The Parade, Birchington.	Agree. To install Double Yellow Lines corner protection to deal with sight lines and reduce potential vehicular conflict.	18/09/14	Out to public consultation.
<u>Lyell Road</u> , Birchington.	Agree. To extend existing lines to deal with sight lines and reduce potential vehicular conflict.	27/03/14	Restrictions marked out and enforceable.
<u>Rossetti Road</u> , Birchington.	Agree. To install Double Yellow Lines to deal with sight lines and reduce potential vehicular conflict.	18/09/14	Out to public consultation.
<u>Dickens Road</u> j/w Eastern Esplanade, Broadstairs.	Agree. To install Double Yellow Lines corner protection to deal with sight lines and reduce potential vehicular conflict.	18/09/14	Out to public consultation.
<u>Green Lane</u> , Broadstairs.	Agree. To extend Double Yellow Lines around the roundabout to deal with inconsiderate parking.	27/03/14	Restrictions marked out and enforceable.
<u>Leybourne Road</u> j/w Western Esplanade, Broadstairs.	Agree. To install Double Yellow Lines corner protection to deal with sight lines and reduce potential vehicular conflict.	18/09/14	Out to public consultation.
<u>Osbourne Road</u> , Broadstairs.	Agree. To install Double yellow lines from the junction with Seafield Road to the junction with The Vale to deal with sight line issues, reduce potential vehicular conflict.	18/09/14	Out to public consultation.
<u>Queens Gardens</u> , Westcliff Avenue & Victoria Parade Broadstairs	Agree. Add into Broadstairs Victoria resident's scheme with shared pay and display and re-design the Victoria Parade end outside the golf course.	23/11/11	Scheme drawn up and awaiting Public Consultation.
<u>Seapoint Road</u> j/w Western Esplanade, Broadstairs.	Agree. To install Double Yellow Lines corner protection to deal with sight lines and reduce potential vehicular conflict.	18/09/14	Out to public consultation.
<u>West Cliff Road</u> , Broadstairs.	Agree. To extend Double Yellow Lines across the boundary of 47 to deal with inconsiderate parking and vehicular conflict.	18/09/14	Out to public consultation.

<u>Westover Road, Broadstairs.</u>	Agreed. To reduce the Double Yellow Lines to allow more parking for residents.	18/09/14	Out to public consultation.
<u>Westwood Road, Broadstairs.</u>	Agree. To extend Double Yellow Lines across the boundary of 143 to deal with inconsiderate parking and vehicular conflict.	18/09/14	Out to public consultation.
<u>Wrotham Road, Broadstairs.</u>	Agree. To install a disabled persons parking bay at the side of 23 Victoria Parade.	18/09/14	Out to public consultation.
<u>All Saints Avenue, Margate.</u>	Agree. To remove Disabled bays and make them time limited bays.	27/03/14	Restrictions marked out and enforceable.
<u>Approach Road, j/w Arundel Road, Margate</u>	Agree. To install Double Yellow line corner protection to deal with sight lines, reduce potential vehicular conflict.	27/03/14	Restrictions marked out and enforceable.
<u>Approach Road, j/w Talbot Road, Margate</u>	Agree. To install Double Yellow line corner protection to deal with sight lines, reduce potential vehicular conflict.	27/03/14	Restrictions marked out and enforceable.
<u>Bath Road j/w Clifton Street and Bath Place, Margate.</u>	Agree. To change Single Yellow Lines to Double Yellow Line corner protection on all junctions to deal with sight line issues, reduce potential vehicular conflict and to keep junction clear.	27/03/14	Restrictions marked out and enforceable.
<u>Cecil Street, and Hawley Square Margate.</u>	Agree. To install kerb markings from the junction with Cecil Square across of the Council Offices up to the boundary of 50/51 Hawley Square to deal with sight line issues, reduce potential vehicular conflict and to keep junction clear	19/12/13	Restrictions marked out and enforceable.
<u>Cedar Close j/w Northdown Park Road, Margate.</u>	Agree. Double Yellow Line corner protection on junction to deal with sight line issues, reduce potential vehicular conflict and to keep junction clear.	19/12/13	Restrictions marked out and enforceable.
<u>Channel Road, Margate.</u>	Agree. To install Double Yellow Line across the access's to deal with sight line issues and reduce potential vehicular conflict and keep the access clear.	18/09/14	Out to public consultation.
<u>College Road, Margate.</u>	Agree. To extend Double yellow lines from outside the clinic to the pedestrian crossing to deal with sight line issues, reduce potential vehicular conflict.	27/03/14	Restrictions marked out and enforceable.
<u>Enterprise Road j/w Strasbourg Street and Channel Road, Margate.</u>	Agree. Double Yellow Line corner protection on junction to deal with sight line issues, reduce potential vehicular conflict and to keep junction clear.	18/09/14	Out to public consultation.
<u>Farley Road, Margate.</u>	Agree. Double yellow lines from the junction with Ramsgate Road to deal with sight line issues, reduce potential vehicular conflict and to keep the junction clear.	19/12/13	Restrictions marked out and enforceable.

<u>George V Avenue, Margate.</u>	Agree. To install Double Yellow line corner protection to deal with sight lines, reduce potential vehicular conflict coming out of Westfield Road.	18/09/14	Out to public consultation.
<u>Grotto Hill & Clifton Gardens, Margate.</u>	Agree. To install Double Yellow Lines on both sides from Dane Road to Grotto Gardens, on one side from Grotto Gardens to Brockely Road and extend the lines from Northdown Road to Brockely Road to deal with sight line issues, reduce potential vehicular conflict and to keep the junction clear.	18/09/14	Out to public consultation.
<u>Half Mile Ride, Margate.</u>	Agree. To install Double Yellow line and corner protection to deal with sight lines, reduce potential vehicular conflict in to the Manston Road waste and recycling site.	18/09/14	Out to public consultation.
<u>Hartsdown Road, j/w George V Avenue, Margate.</u>	Agree. To install Double Yellow line corner protection to deal with sight lines, reduce potential vehicular conflict.	18/09/14	Out to public consultation.
<u>Hartsdown Road, Margate</u>	Agree. To extend double yellow lines to reduce potential vehicular conflict.	19/12/13	Restrictions marked out and enforceable.
<u>High Street, Margate</u>	Agree. Extend hours of pedestrian access for Margate.	14/03/13	Informal Consultation May 2013. Order being drawn up by KCC Consultant.
<u>Manston Road, Margate.</u>	Agree. To install single yellow lines form the junction with Shottendane Road on one side to the junction with Sycamore Close to reduce potential vehicular conflict.	19/12/13	Restrictions marked out and enforceable.
<u>Northdown Road, Margate</u>	Agree. To change first bay from pay and display to double yellow lines with kerb markings to reduce potential vehicular conflict and improve sight lines.	27/03/14	Restrictions marked out and enforceable.
<u>Tivoli Park Avenue, j/w Tivoli Road, Margate.</u>	Agree. To extend existing lines to reduce potential vehicular conflict and keep access clear.	19/12/13	Restrictions marked out and enforceable.
<u>Tivoli Road, Margate.</u>	Agree. To install time limited bays to help business with the turnover of vehicles to help with trade.	18/09/14	Out to public consultation.
<u>Warwick Road, Margate.</u>	Agree. To install a disabled persons parking bay in front of number 4 Warwick Road.	18/09/14	Out to public consultation.
<u>Westfield Road, j/w Argyle Avenue Margate.</u>	Agree. To install Double Yellow line corner protection to deal with sight lines, reduce potential vehicular conflict.	27/03/14	Restrictions marked out and enforceable.

<u>Wydhams Avenue, j/w Lyndhurst Avenue, Margate.</u>	Agree. To install Double Yellow Lines on one side of the junction for corner protection to keep the junction clear and reduce potential vehicular conflict.	19/12/13	Restrictions marked out and enforceable.
<u>Canterbury Road West, j/w Cliff View Road, Foads Hill, King Arthur Road, Sea View Road and Arundel Road, Ramsgate.</u>	Agree. To install Double Yellow Lines corner protection at all junctions to deal with sight line issues, reduce potential vehicular conflict and to keep junction clear.	27/03/14	Restrictions marked out and enforceable.
<u>Eldon Grove, j/w Wilsons Road, Ramsgate.</u>	Agree. To install Double Yellow lines corner protection to deal with sight lines, to reduce potential vehicular conflict and keep the junction clear.	27/03/14	Restrictions marked out and enforceable.
<u>Foads Lane, j/w Cottington Road, Ramsgate.</u>	Agree. Corner protection on junction to deal with sight line issues, reduce potential vehicular conflict and to keep junction clear.	27/03/14	Restrictions marked out and enforceable.
<u>Grange Road, Ramsgate.</u>	Agree. To reduce the Double Yellows lines outside 5 Windmill Parade to give more visitor parking.	18/09/14	Out to public consultation.
<u>Harbour Street, King Street, Queens Street, Ramsgate</u>	Agreed. Extend the days of pedestrian access for Ramsgate.	14/03/13	Informal Consultation May 2013. Order being drawn up by KCC Consultant.
<u>High Street, Ramsgate.</u>	Agree. To Extend the loading bay and remove the un used bus stop clearway outside 73-75 High Street.	18/09/14	Out to public consultation.
<u>Lyndhurst Road, Ramsgate.</u>	Agree. To install a disabled persons parking bay in front of number 11 Lyndhurst Road.	18/09/14	Out to public consultation.
<u>Military Road, Ramsgate.</u>	Agree. To install Double Yellow Lines along both sides for the entire length with kerb markings from the junction with Royal Parade to the end of the inner harbour to reduce inconsiderate parking and potential vehicular conflict.	18/09/14	Out to public consultation.
<u>Montefiore Avenue, j/w Dumpton Park Drive, Ramsgate.</u>	Agree. To install Double Yellow lines corner protection and to extend existing lines to deal with sight lines, to reduce potential vehicular conflict and keep the junction clear.	18/09/14	Out to public consultation.
<u>Muir Road, j/w Dumpton Park Drive, Ramsgate.</u>	Agree. To install Double Yellow lines corner protection to deal with sight lines, to reduce potential vehicular conflict and keep the junction clear.	18/09/14	Out to public consultation.

<u>Queen Street, j/w Cliff Street, Ramsgate</u>	Agree. To extend existing lines and place kerb markings to reduce potential vehicular conflict and keep access and junction clear.	27/03/14	Restrictions marked out and enforceable.
<u>School Lane, Ramsgate.</u>	Agree. Corner protection on one side to reduce potential vehicular conflict.	19/12/13	Restrictions marked out and enforceable.
<u>Silverdale Road, j/w Pegwell Road, Ramsgate.</u>	Agree. To install Double Yellow lines corner protection to deal with sight lines, to reduce potential vehicular conflict and keep the junction clear.	18/09/14	Out to public consultation.
<u>Southwood Road, j/w Southwood Heights, Ramsgate.</u>	Agree. Corner protection on junction to deal with sight line issues, reduce potential vehicular conflict and to keep junction clear.	19/12/13	Restrictions marked out and enforceable.
<u>St Georges Road, Ramsgate.</u>	Agree. To install a disabled persons parking bay in front of number 10 St Georges Road.	18/09/14	Out to public consultation.
<u>Belmont Road, Westgate.</u>	Agree. To install a disabled persons parking bay in front of number 86 Belmont Road.	18/09/14	Out to public consultation.
<u>Harold Avenue j/w St Mildreds Road, Westbury Road, Westgate.</u>	Agree. Corner protection on junction and on the inner bend of the road to deal with sight line issues, reduce potential vehicular conflict and to keep junction clear.	3/9/13	Restrictions marked out and enforceable.

This page is intentionally left blank

PARKING PLACES FOR DISABLED PERSONS VEHICLES – THANET VARIOUS

To: Thanet Joint Transportation Board – 16 December 2014

By: Civil Enforcement Manager

Classification: Unrestricted

Ward: Across the District - Various

Summary: To report upon the request to provide parking places for disabled persons vehicles in Thanet.

For Decision: Members are requested to recommend that the parking places for disabled persons vehicles are advertised for public comment/objection.

1.0 Introduction and Background

- 1.1 Kent County Council, as traffic authority, has the power to designate part of the highway as an on-street parking place and control the type of vehicle and the terms and conditions of its use under the Road Traffic Regulation Act 1984, Sections 32 and 35.
- 1.2 Therefore, Thanet District Council, acting on behalf of Kent County Council can provide special parking bays on streets for disabled people who have substantial difficulties in walking and parking in the vicinity of their property.

2.0 The Current Situation

- 2.1 One application for parking places for disabled person's vehicles have been processed and have been agreed and an interim parking place has been introduced. This means that the bay is marked on the road but will not be legal and therefore cannot be enforced.
- 2.2 Once a legal Traffic Regulation Order is made a sign is erected and the bay is legal and can be enforced.
- 2.3 1 application for parking places for disabled person's vehicles has been agreed and is listed in annex 1
- 2.4 If Members endorse the recommendations, they will be formally advertised in the usual way for public comment/objection. A notice is placed in a free local newspaper and notices are placed 'on street'. If objections are received on traffic related matters they will be referred to Members who will recommend whether to amend, abandon or introduce the parking places for disabled person's vehicles as advertised.

3.0 Options

- 3.1.1 1 – Advertise - The parking places for disabled persons vehicles as listed in annex 1 would be exposed for formal public consultation.
- 3.1.2 2 – Take no further action - The parking places for disabled persons vehicles as listed in annex 1 would not be exposed for formal public consultation and therefore could not be enforced.

4.0 Corporate Implications

4.1 Financial

- 4.1.1 The work associated with the Traffic Regulation Order for parking places for disabled person vehicles would be funded, managed and enforced by the Thanet District Council using the 'decriminalisation budget'.

4.2 Legal

- 4.2.1 Kent County Council, as traffic authority, has the power to designate part of the highway as an on-street parking place and control the type of vehicle and the terms and conditions of its use under the Road Traffic Regulation Act 1984, Sections 32 and 35.

4.3 Corporate

- 4.3.1 The proposal will benefit all blue badge holders that may need to park in the Thanet area as on street disabled persons parking bays are for any vehicle that is displaying a valid blue badge. With out a Traffic Regulation Order on the disabled persons parking bays the bays cannot be kept clear for blue badge holders.

4.4 Equity and Equalities

- 4.4.1 By advertising the disabled drivers parking bays as part of the Traffic Regulation Order making process the Order can be made, a sign can be erected and the bay will be legal and can be enforced. This will benefit the holders of blue badges and give them greater independence to lead their lives.

5.0 Recommendation(s)

- 5.1 Members are requested to recommend option 1- that the parking places for disabled person's vehicles as listed in annex 1 would be exposed for formal public consultation.
- 5.2 That the proposals which require statutory consultation are advertised, and that any traffic related objections are reported back to a future meeting of the Board.

Contact Officer:	<i>Robin Chantrill-Smith (Civil Enforcement Manager) 01843 577472</i>
Reporting to:	<i>Gavin Waite (Head of Operational Services) 01843 577840</i>

Background Papers None

Annex List

<i>Annex 1</i>	<i>List of sites and site plans of Disabled persons parking bays to be advertised.</i>
----------------	--

ROADS IN RAMSGATE

CHICHESTER ROAD Across the frontage of 13-21
Chichester Road.

This page is intentionally left blank

Chichester Road, Ramsgate. Site Plan

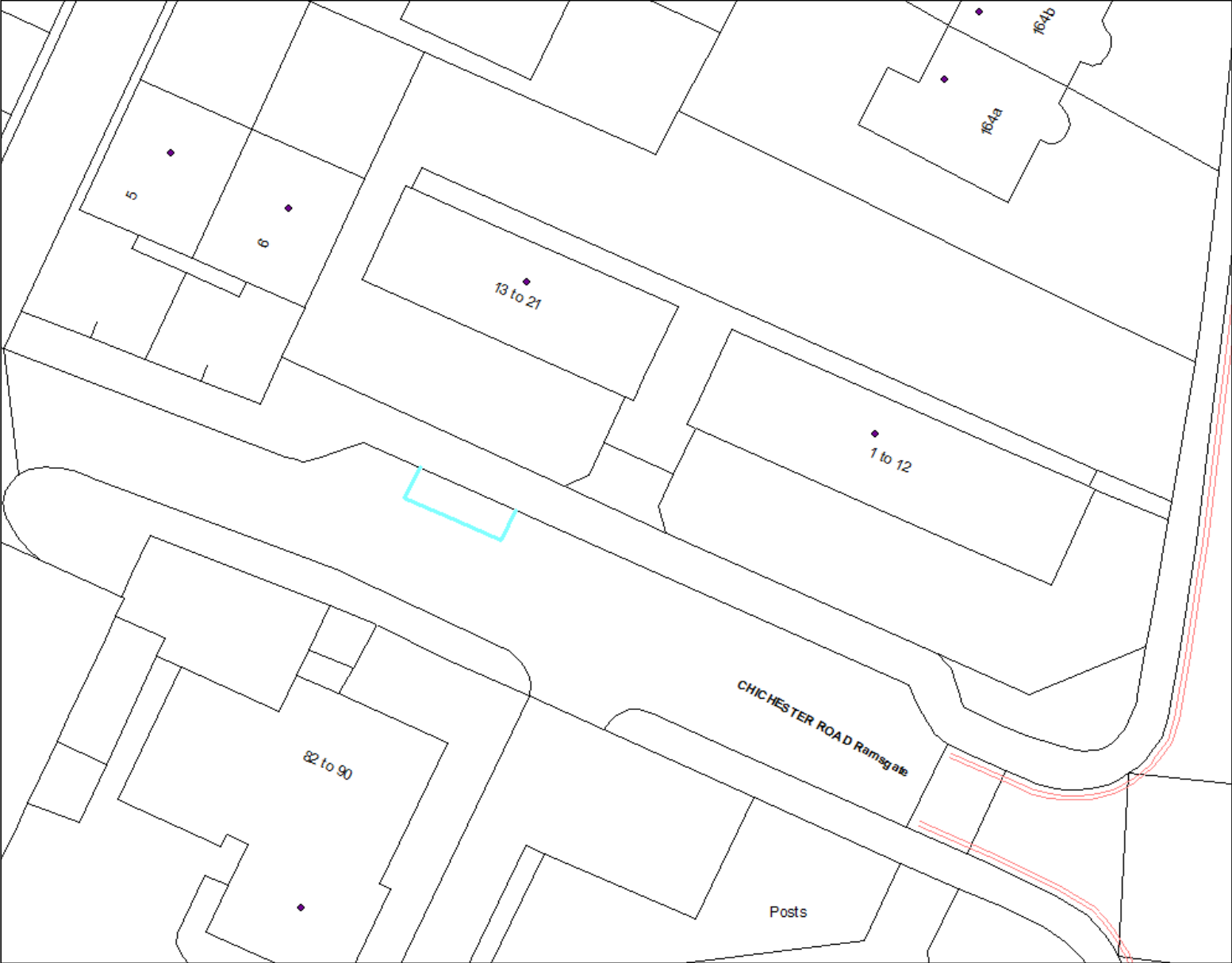

Disabled bay in front of 13-21 Chichester Road Ramsgate



Chichester Road,
Ramsgate

SLI 100018261

This page is intentionally left blank